



**To: All Vendors Bidding on The College of New Jersey  
Pedestrian Path Project**

**From: Anup Kapur  
Finance & Business Services**

**Date: April 28, 2021**

---

**ADDENDUM NO. 1**

**ISSUE DATE: May 3, 2021**

**REFERENCE:** The College of New Jersey  
Pedestrian Path Project  
Project No. AB210018

Date of Original Bidding Documents: April 21, 2021

**INTENT:** This Addendum forms a part of the Contract Documents and modifies the original Bidding Documents and Prior Addenda if any, as identified above. Acknowledge receipt of this Addendum in the space provided on the Bid Form. Failure to do so may subject Bidder to disqualification.

---

**TCNJ Clarification: See attached updated specifications/drawings.**

**Vendor Questions:**

- 1. Question:** The documents for the captioned project indicate that the bidder must possess a DPMC C059 classification for road construction and paving. There was only one other bidder at today's pre-bidding meeting. We respectfully request reconsideration of this requirement to include contractors with a C008/C009 classification (General Construction / Alterations). Granting this request will benefit the College as it will garner a greater interest and subject the College to receipt of a greater number of bids. Kindly advise if this can be revisited to include those with the C008/C009 classification.

**TCNJ Response:** Bidder must have DPMC C059 rating, road construction & paving.

**Clarifications:**

1. Contractor to remove all excess materials from campus and dispose of accordingly.
2. Contractor to include in base bid: Supply and Installation of four 6 foot to 8 foot White Pines (Pinus strobus).



3. Contractor to work with College and Consultant to mark out final approved pedestrian path alignment in the field prior to construction.

**ATTACHMENTS:**

Pre-bid Sign in sheet.

Drawings 01 through 05, with revisions clouded.

**END OF ADDENDUM NO. 1**



Pedestrian Path Project  
Pre-bid Meeting  
April 23, 2021, 10:00 am

Meeting Sign-In Sheet

	<u>Name</u>	<u>Company</u>	<u>Cell Phone</u>	<u>Email</u>
1	Mumtaz Makhdomi	TCNJ, Planning & Construction	609-678-6632	makhdomm@tcnj.edu
2	IT SERVICES	COLLEGE	215-219-4583	ESTRADA, DORIS COLLEGE
3	Rick Galante	Framan Mechanical	856-361-4990	Dmangiolielli@frama mechanical.com
4	Guy Ponticello	Phil and Son	609-207-7443	Phil and Son Enterprises net
5				
6				
7				
8				
9				
10				
11				
12				
13				
14				

# SITE PLAN FOR THE COLLEGE OF NEW JERSEY TCNJ PEDESTRIAN PATH BLOCK 215, LOT 38 EWING TOWNSHIP MERCER COUNTY, NEW JERSEY

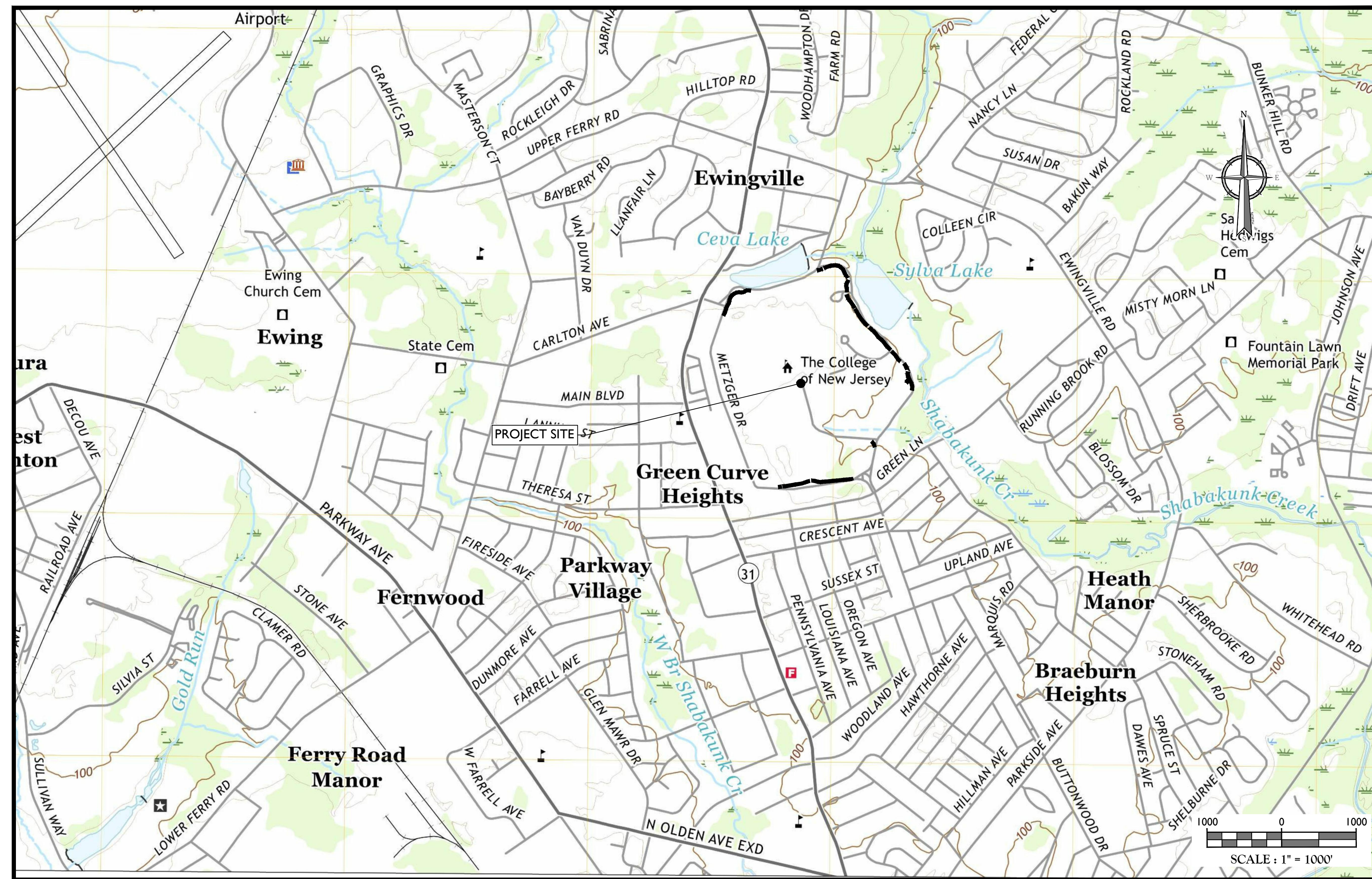
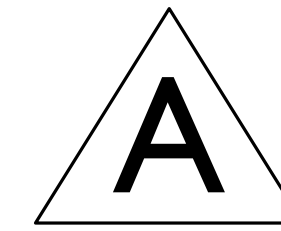

### KEY MAP

SOURCE: USGS LOCATION MAP

### GENERAL INFORMATION

1. THE SUBJECT PROPERTY IS KNOWN AS VARIOUS LOTS IN BLOCK 215 AS SHOWN ON THE OFFICIAL TAX MAP OF THE EWING TOWNSHIP, MERCER COUNTY, NEW JERSEY.
2. THE PROPERTY IS LOCATED IN THE R-1 ZONE DISTRICT.
3. THE SUBJECT PROPERTY IS PRESENTLY DEVELOPED. THE APPLICANT PROPOSES TO CONSTRUCT A POROUS PAVEMENT TRAIL CONNECTING EXISTING PATHS AROUND THE CAMPUS.
4. THE TOPOGRAPHIC INFORMATION SHOWN HEREON WAS COMPILED FROM TOPOGRAPHIC FIELD SURVEY DATA OBTAINED BY COLLIER ENGINEERING & DESIGN, ON MARCH 05, 2021.
5. THE HORIZONTAL DATUM IS RELATIVE TO THE NEW JERSEY STATE PLANE COORDINATE SYSTEM AND ADJUSTED TO NAD1983. THE VERTICAL DATUM IS RELATIVE TO NAVD 1988.
6. BENCHMARK REFERENCE: THE VERTICAL AND HORIZONTAL DATUM WERE ESTABLISHED AT THE PROJECT SITE BY USING GPS SURVEY METHODS.
7. GEOTECHNICAL INFORMATION SHOWN HEREON ARE AS OBTAINED FROM THE NATURAL RESOURCES AND CONSERVATION SERVICES. WEB SOIL SURVEY.
8. THIS SET OF PLANS IS NOT DEPICTING ENVIRONMENTAL CONDITIONS OR A CERTIFICATION/WARRANTY REGARDING THE PRESENCE OR ABSENCE OF ENVIRONMENTALLY IMPACTED SITE CONDITIONS. MASER CONSULTING HAS PERFORMED NO EXPLORATORY OR TESTING SERVICES. INTERPRETATIONS, CONCLUSIONS OR OTHER SITE ENVIRONMENTAL SERVICES RELATED TO THE DETERMINATION OF THE POTENTIAL FOR CHEMICAL, TOXIC, RADIOACTIVE OR OTHER TYPE OF CONTAMINANTS AFFECTING THE PROPERTY AND THE UNDERSIGNED PROFESSIONAL IS NOT QUALIFIED TO DETERMINE THE EXISTENCE OF SAME. SHOULD ENVIRONMENTAL CONTAMINATION OR WASTE BE DISCOVERED, THE OWNER AND CONTRACTOR SHALL BE RESPONSIBLE FOR COMPLYING WITH ALL APPLICABLE LAWS AND REGULATIONS.
9. THIS IS A SITE DEVELOPMENT PLAN AND UNLESS SPECIFICALLY NOTED ELSEWHERE HEREON, IS NOT A SURVEY.
10. DO NOT SCALE DRAWINGS AS THEY PERTAIN TO ADJACENT AND SURROUNDING PHYSICAL CONDITIONS, BUILDINGS, STRUCTURES, ETC. THEY ARE SCHEMATIC ONLY, EXCEPT WHERE DIMENSIONS ARE SHOWN THERETO.
11. THE CONTRACTOR IS RESPONSIBLE FOR PROJECT SAFETY, INCLUDING PROVISION OF ALL APPROPRIATE SAFETY DEVICES AND TRAINING REQUIRED.
12. PRIOR TO ANY EXCAVATION, THE CONTRACTOR SHALL CALL 811 TO REQUEST A UTILITY MARKOUT AND COORDINATE WITH TCNJ MARKOUTS.

### SITE NOTES

1. CURB RAMPS ARE TO BE CONSTRUCTED FLUSH WITH THE FINISHED PAVEMENT SURFACE. ACCESSIBLE CURB RAMPS INSTALLED WITHIN THE PUBLIC RIGHT OF WAY ARE TO HAVE DETECTABLE WARNING SURFACES COMPLIANT WITH FEDERAL ACCESSIBILITY GUIDELINES FOR PEDESTRIAN FACILITIES IN THE PUBLIC RIGHT OF WAY.
2. CONTRACTOR IS TO PROVIDE PROPER TRAFFIC CONTROL MEASURES REQUIRED TO MAINTAIN THE FLOW OF TRAFFIC IN EACH DIRECTION DURING THE EXCAVATIONS/INSTALLATIONS IF A LANE OF TRAFFIC WILL BE IMPACTED BY THE CONTRACTOR'S OPERATIONS. THIS WILL INCLUDE BUT NOT BE LIMITED TO SIGNAGE AND FLAG PERSONNEL.
3. TRAFFIC SIGNAGE AND STRIPING SHALL CORRESPOND TO THE MANUAL ON UNIFORM TRAFFIC CONTROL DEVICES.
4. REFUSE AND RECYCLABLES SHALL BE STORED WITHIN OUTSIDE SCREENED TRASH ENCLOSURES, AND PICKED UP BY PRIVATE WASTE DISPOSAL HAULER.
5. CONTRACTOR SHALL BE RESPONSIBLE FOR THE PROPER DISPOSAL OF ALL WASTE MATERIALS IN ACCORDANCE WITH GOVERNING REGULATIONS AND AGENCIES.
6. THERE SHALL BE NO ON-SITE BURIAL OF CONSTRUCTION MATERIALS, TREE BRANCHES, STUMPS, OR OTHER DELETERIOUS MATERIALS.
7. CONTRACTOR TO DISPOSE OF ALL EXCESS MATERIALS, SOILS, ETC. DAILY AS THE PROJECT PROGRESSES. MATERIAL TO BE STOCKPILED ALONG TRAIL TOPOSOIL TO BE REUSED. ALL OTHER MATERIALS TO IMMEDIATELY BE REMOVED FROM THE TCNJ PROPERTY.
8. CONTRACTOR IS TO CLEAN SITE DAILY & PLACE TOPSOIL IMMEDIATELY AFTER EACH PAVING SECTION PER DAY, SEED & STABILIZE AS THE PROJECT PROGRESSES.
9. MATERIALS, WORKMANSHIP, AND CONSTRUCTION FOR THE SITE IMPROVEMENTS SHOWN HEREON SHALL BE IN ACCORDANCE WITH:
  - A. NEW JERSEY DEPARTMENT OF TRANSPORTATION "STANDARD SPECIFICATIONS FOR ROAD AND BRIDGE CONSTRUCTION", 2019, AS SUPPLEMENTED.
  - B. CURRENT PREVAILING COUNTY, AND/OR STATE AGENCY SPECIFICATIONS, STANDARDS, CONDITIONS, AND REQUIREMENTS.
  - C. CURRENT PREVAILING UTILITY COMPANY/AUTHORITY SPECIFICATIONS, STANDARDS, AND REQUIREMENTS.
  - D. CURRENT MANUFACTURER SPECIFICATIONS, STANDARDS, AND REQUIREMENTS.

### UTILITY NOTES

1. EXISTING UTILITY INFORMATION SHOWN HEREON HAS BEEN COLLECTED FROM VARIOUS SOURCES AND IS NOT GUARANTEED AS TO ACCURACY OR COMPLETENESS. THE CONTRACTOR SHALL VERIFY ALL INFORMATION TO HIS SATISFACTION PRIOR TO EXCAVATION. WHERE EXISTING UTILITIES ARE TO BE CROSSED BY PROPOSED CONSTRUCTIONS, TEST PITS SHALL BE DUG BY THE CONTRACTOR PRIOR TO CONSTRUCTION TO ASCERTAIN EXISTING INVERTS, MATERIALS, AND SIZES. TEST PIT INFORMATION SHALL BE GIVEN TO THE ENGINEER PRIOR TO CONSTRUCTION TO PERMIT ADJUSTMENTS AS REQUIRED TO AVOID CONFLICTS. THE CONTRACTOR SHALL NOTIFY THE UNDERSIGNED PROFESSIONAL IMMEDIATELY IF ANY FIELD CONDITIONS ENCOUNTERED DIFFER MATERIALLY FROM THOSE REPRESENTED HEREON. SUCH CONDITIONS COULD RENDER THE DESIGNS HEREON INAPPROPRIATE OR INEFFECTIVE.
2. UTILITY RELOCATIONS SHOWN HEREON, IF ANY, ARE FOR INFORMATIONAL PURPOSES ONLY AND MAY NOT REPRESENT ALL REQUIRED UTILITY RELOCATIONS. THE CONTRACTOR IS RESPONSIBLE FOR PERFORMING AND/OR COORDINATING ALL REQUIRED UTILITY RELOCATIONS IN COOPERATION WITH THE RESPECTIVE UTILITY COMPANY/AUTHORITIES.

### ADA INSTRUCTIONS TO CONTRACTOR:

1. CONTRACTOR SHALL EXERCISE APPROPRIATE CARE AND PRECISION IN CONSTRUCTION OF ADA (HANDICAPPED) ACCESSIBLE COMPONENTS FOR THE SITE. THESE COMPONENTS, AS CONSTRUCTED, MUST COMPLY WITH THE LATEST ADA STANDARDS FOR ACCESSIBLE DESIGN. FINISHED SURFACES ALONG THE ACCESSIBLE ROUTE OF TRAVEL FROM PARKING SPACE, PUBLIC TRANSPORTATION, PEDESTRIAN ACCESS, INTER-BUILDING ACCESS, TO POINTS OF ACCESSIBLE BUILDING ENTRANCE/EGRESS, SHALL COMPLY WITH THESE ADA CODE REQUIREMENTS. THESE INCLUDE, BUT ARE NOT LIMITED TO THE FOLLOWING:
 

**NOTE: THIS LIST IS NOT INTENDED TO CAPTURE EVERY APPLICABLE FEDERAL, STATE AND LOCAL RULE AND REGULATION. THE CONTRACTOR IS RESPONSIBLE FOR COMPLIANCE WITH THE LAW, WHETHER OR NOT STATED SPECIFICALLY HEREIN:**

  - A. PARKING SPACES AND PARKING AISLES - SLOPE SHALL NOT EXCEED 1:48 (1/4" PER FOOT OR NOMINALLY 2.0%) IN ANY DIRECTION.
  - B. CURB RAMPS - SLOPES SHALL NOT EXCEED 1:12 (8.3%).
  - C. LANDINGS - SHALL BE PROVIDED AT EACH END OF RAMPS. SHALL PROVIDE POSITIVE DRAINAGE AND SHALL NOT EXCEED 1:48 (1/4" PER FOOT OR NOMINALLY 2.0%) IN ANY DIRECTION.
  - D. PATH OF TRAVEL ALONG ACCESSIBLE ROUTE - SHALL PROVIDE A 36 INCH OR GREATER UNOBSTRUCTED WIDTH OF TRAVEL. (CAR OVERHANGS CANNOT REDUCE THIS MINIMUM WIDTH). THE SLOPE SHALL BE NO GREATER THAN 1:20 (5.0%) IN THE DIRECTION OF TRAVEL, AND SHALL NOT EXCEED 1:48 (1/4" PER FOOT OR NOMINALLY 2.0%) IN CROSS SLOPE.
  - E. WHERE PATH OF TRAVEL WILL BE GREATER THAN 1:20 (5.0%), AN ADA RAMP WITH A MAXIMUM SLOPE OF 1:12 (8.3%), FOR A MAXIMUM DISTANCE OF 30 FEET, SHALL BE PROVIDED. THE RAMP SHALL HAVE ADA HAND RAILS AND "LEVEL" LANDINGS ON EACH END THAT ARE SLOPED NO MORE THAN 1:48 (1/4" PER FOOT OR NOMINALLY 2.0%) FOR POSITIVE DRAINAGE.
  - F. DOORWAYS - SHALL HAVE A "LEVEL" LANDING AREA ON THE EXTERIOR SIDE OF THE DOOR THAT IS SLOPED NO MORE THAN 1:48 (1/4" PER FOOT OR NOMINALLY 2.0%) FOR POSITIVE DRAINAGE. THIS LANDING AREA SHALL BE NO LESS THAN 60 INCHES (5 FEET) LONG, EXCEPT WHERE OTHER WISE PERMITTED BY ADA STANDARDS FOR ALTERNATIVE DOORWAY OPENING CONDITIONS (SEE APPLICABLE CODE SECTIONS).



Engineering  
& Design

www.colliersengineering.com

Copyright © 2021, Colliers Engineering & Design. All rights reserved. No sharing or all the information contained herein is authorized for use only by the party for which the services were contracted or to whom it is provided. This drawing shall not be copied, revised, discarded, distributed or relied upon for any other purpose without the express written consent of Colliers Engineering & Design.

Doing Business as MASER

PROTECT YOURSELF. ALL STATES REQUIRE NOTIFICATION OF EXCAVATORS, OPERATORS, OR ANY PERSON PREPARING TO DISTURB THE EARTH'S SURFACE TO CALL 811. VISIT: WWW.CALL811.COM

FOR STATE SPECIFIC DIRECT PHONE NUMBERS VISIT: WWW.CALL811.COM

REV.	DATE	DESCRIPTION

REV.	DATE	DESCRIPTION

REV.	DATE	DESCRIPTION

**Gerald DeFelicis**  
NEW JERSEY LICENSED LANDSCAPE ARCHITECT  
LICENSE NUMBER: AS09571  
COLLIERS ENGINEERING & DESIGN, INC.  
N.J. C.O.A. # 34682798690

**SITE PLAN  
FOR  
THE COLLEGE OF  
NEW JERSEY**

**BLOCK 215  
LOT 38  
EWING TOWNSHIP  
MERCER COUNTY  
NEW JERSEY**

**Colliers**  
Engineering  
& Design

MT. LAUREL  
2000 MOUNTAIN DRIVE,  
SUITE 100  
MT. LAUREL, NJ 08054  
PHONE: 856-797-0412  
COLLIERS ENGINEERING & DESIGN, INC.  
DOING BUSINESS AS MASER  
CONSULTING

SCALE: AS SHOWN DATE: 04/14/21 DRAWN BY: RFP CHECKED BY: GJD  
PROJECT NUMBER: 20002600A DRAWING NAME: C-CVPR

SHEET TITLE:  
**COVER SHEET**

SHEET NUMBER:  
**01 of 05**

### INDEX OF SHEETS

SHT. No.	DESCRIPTION	LATEST REVISION
1	COVER SHEET	
2-4	CONSTRUCTION PLAN	
5	CONSTRUCTION DETAILS	

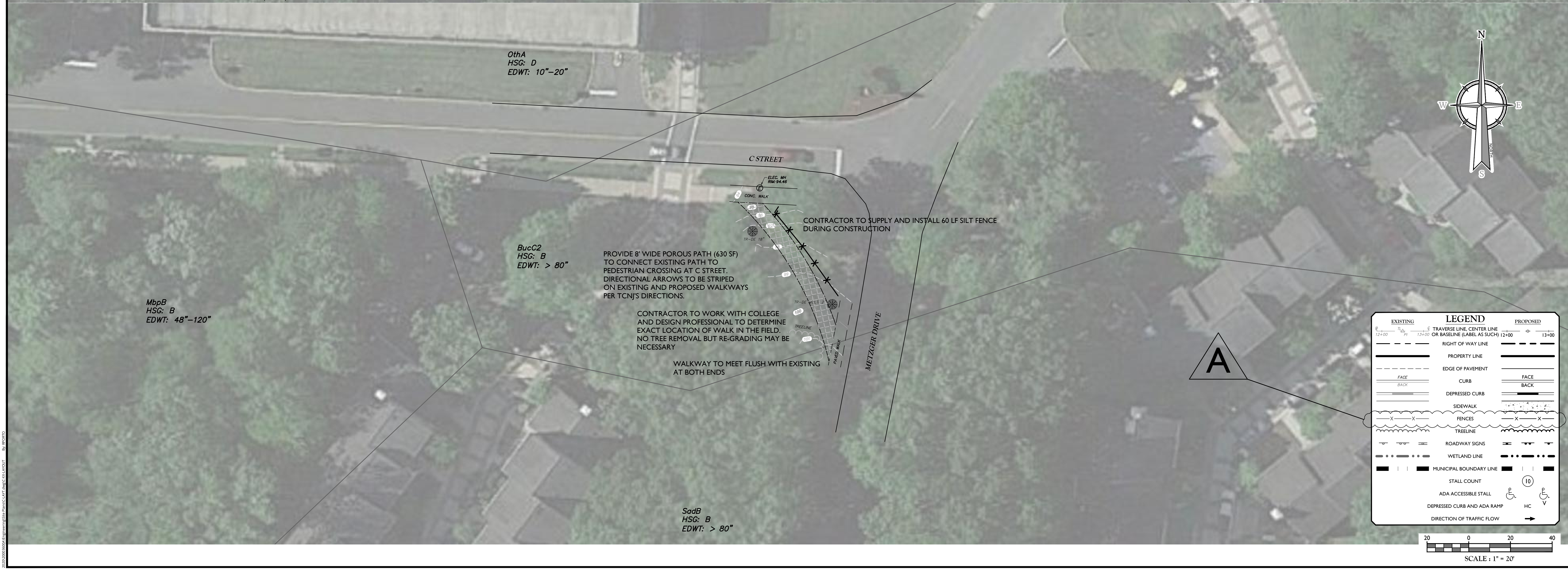
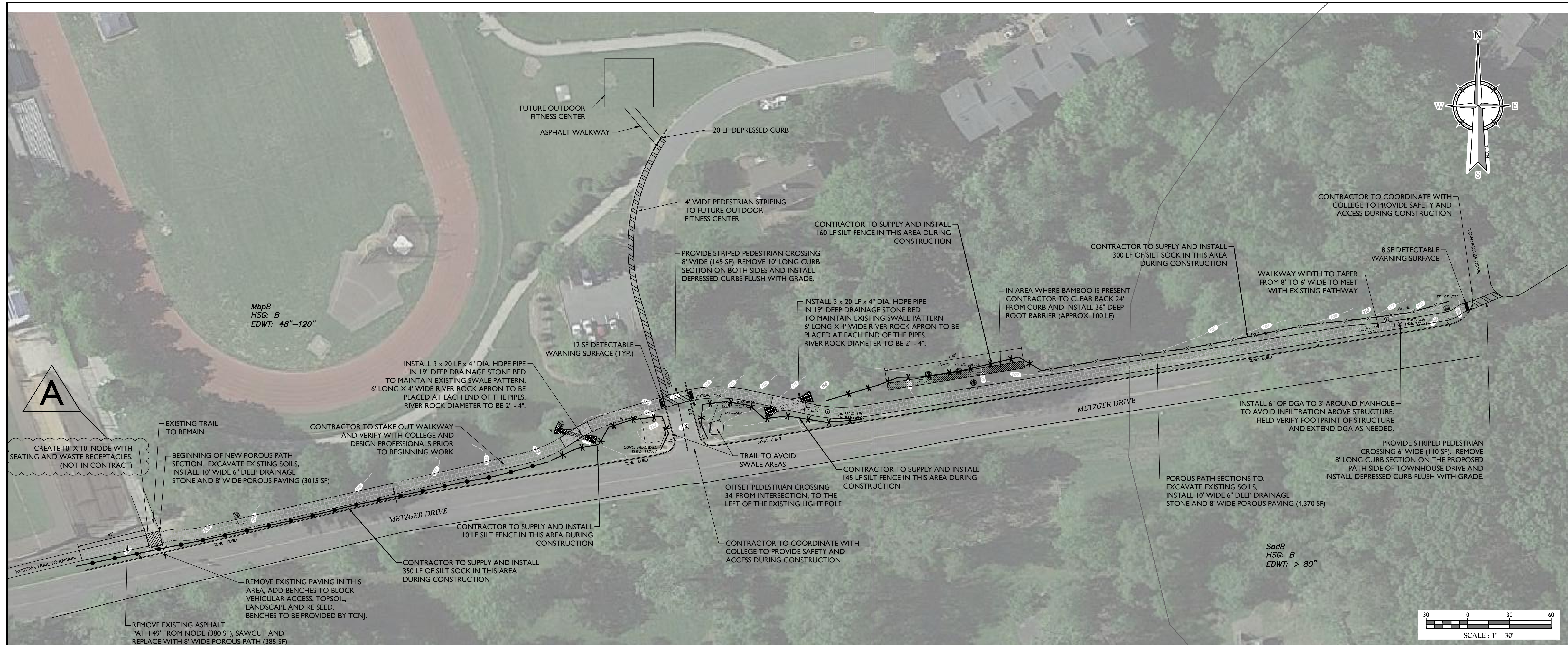

**Colliers**  
Engineering & Design

www.colliersengineering.com

Copyright © 2021 Colliers Engineering & Design, Inc. All rights reserved. This drawing and all the information contained herein is authorized for use only by the party for whom the services were contracted or to whom it is rendered. This drawing may not be copied, revised, discussed, distributed or relied upon for any other purpose without the express written consent of Colliers Engineering & Design.

Doing Business as **MASER**

**811**  
Know what's below.  
Call before you dig.  
FOR STATE SPECIFIC DIRECT PHONE NUMBERS VISIT: WWW.CALL811.COM

PROTECT YOURSELF  
ALL STATES REQUIRE NOTIFICATION OF EDUCATORS, ENGINEERS, OR ANY PERSON PREPARING TO DISTURB THE EARTH'S SURFACE TO REGISTER IN ANY STATE

REV	DATE	DESCRIPTION	DRAWN BY	DESCRIPTION

REV	DATE	DESCRIPTION	DRAWN BY	DESCRIPTION

**Gerald DeFelicis**  
NEW JERSEY LICENSED LANDSCAPE ARCHITECT  
LICENSE NUMBER: AS00571  
COLLIERS ENGINEERING & DESIGN, INC.  
N.J. C.O.A. # 3462796650

**SITE PLAN**  
FOR  
**THE COLLEGE OF NEW JERSEY**  
  
BLOCK 215  
LOT 38  
EWING TOWNSHIP  
MERCER COUNTY  
NEW JERSEY

**Colliers**  
Engineering & Design

MT. LAUREL  
2000 MIDBATIC DRIVE,  
SUITE 100  
MT. LAUREL, NJ 08054  
PHONE: 856.797.0412  
COLLIERS ENGINEERING & DESIGN, INC.  
DOING BUSINESS AS MASER CONSULTING

SCALE: AS SHOWN DATE: 04/14/21 DRAWN BY: RFP CHECKED BY: GJD  
PROJECT NUMBER: 200036004 DRAWING NAME: C-LAY1

**CONSTRUCTION PLAN**  
SHEET NUMBER: 02 of 05

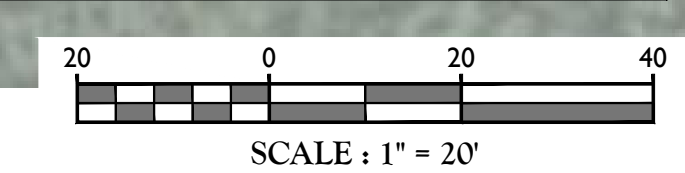
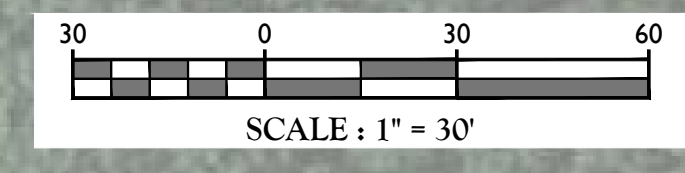
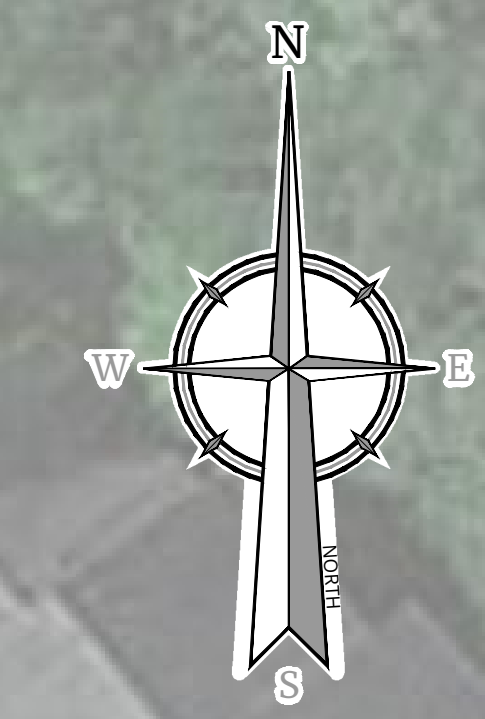

EXISTING	LEGEND	PROPOSED
---	TRaverse LINE, CENTER LINE OR BASELINE (LABEL AS SUCH)	---
---	RIGHT OF WAY LINE	---
---	PROPERTY LINE	---
---	EDGE OF PAVEMENT	---
---	CURB	---
---	DEPRESSED CURB	---
---	SIDEWALK	---
---	FENCES	---
---	TREELINE	---
---	ROADWAY SIGNS	---
---	WETLAND LINE	---
---	MUNICIPAL BOUNDARY LINE	---
---	STALL COUNT	---
---	ADA ACCESSIBLE STALL	---
---	DEPRESSED CURB AND ADA RAMP	---
---	DIRECTION OF TRAFFIC FLOW	---

NOTE: DO NOT SCALE DRAWINGS FOR CONSTRUCTION.

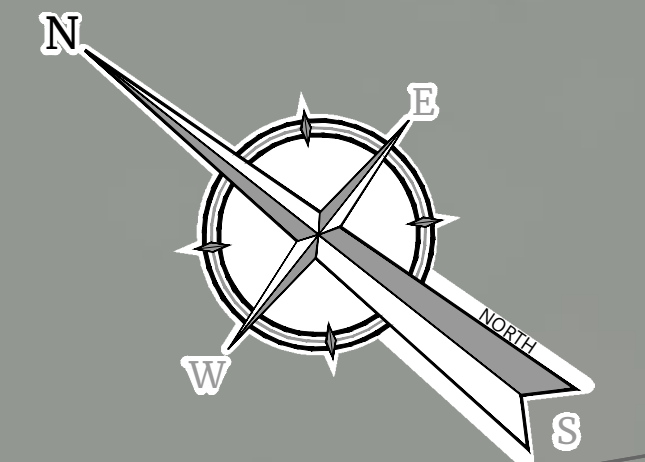

REVISION TABLE with columns for REV, DATE, DRAWN BY, DESCRIPTION, and APPROVAL BY.

Gerald DeFelicis  
NEW JERSEY LICENSED LANDSCAPE ARCHITECT  
LICENSE NUMBER: AS05071  
COLLIERS ENGINEERING & DESIGN, INC.  
N.J. C.O.A. #: 34642798500

SITE PLAN FOR THE COLLEGE OF NEW JERSEY

BLOCK 215 LOT 38  
EWING TOWNSHIP MERCER COUNTY NEW JERSEY

SCALE: AS SHOWN DATE: 04/14/21 DRAWN BY: RFP CHECKED BY: GJD  
PROJECT NUMBER: 20003600A DRAWING NAME: C-LAY1

CONSTRUCTION PLAN

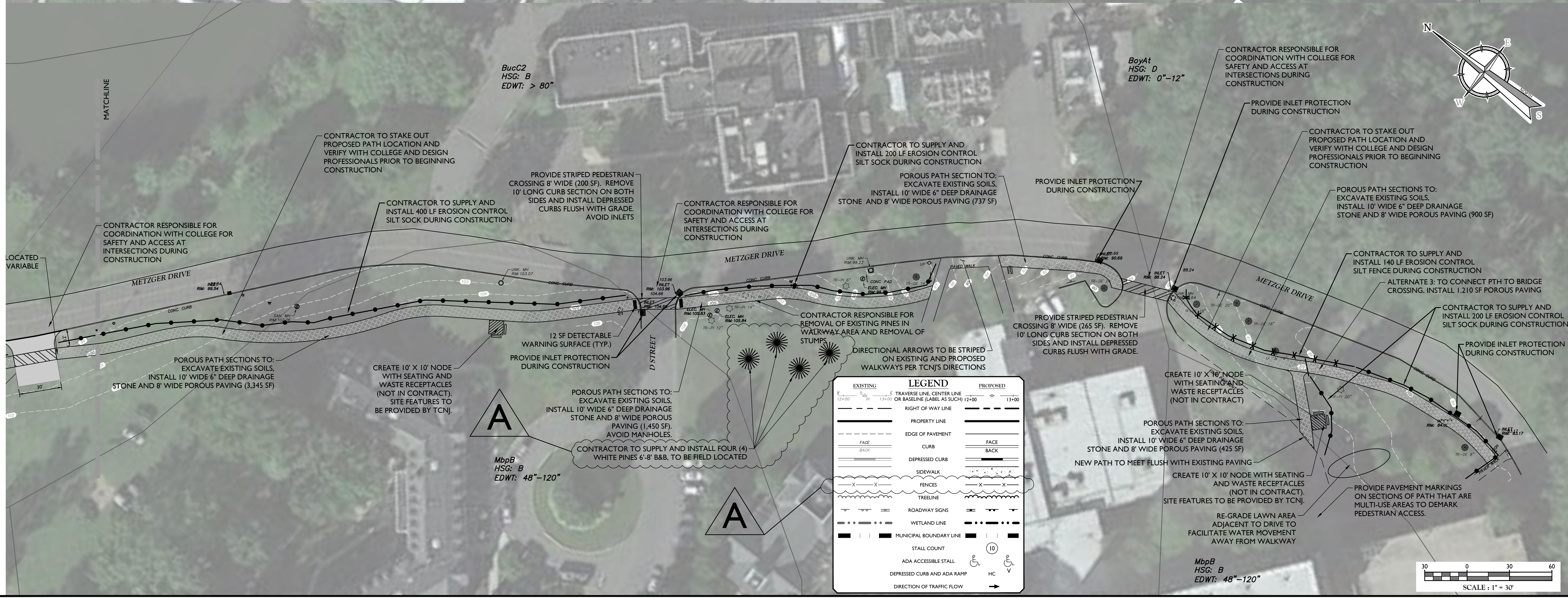
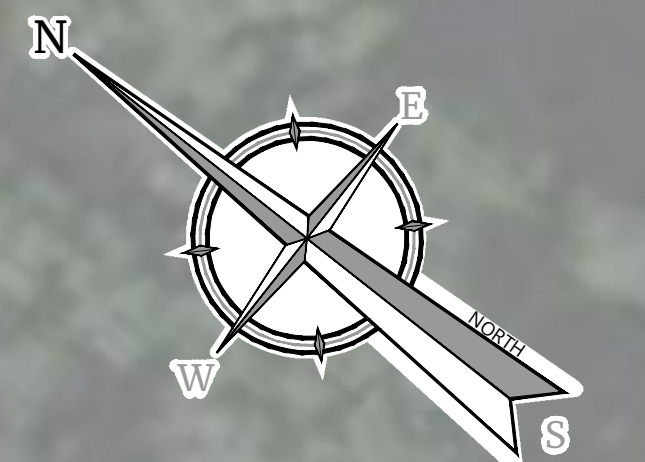
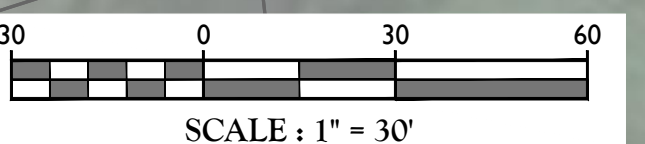
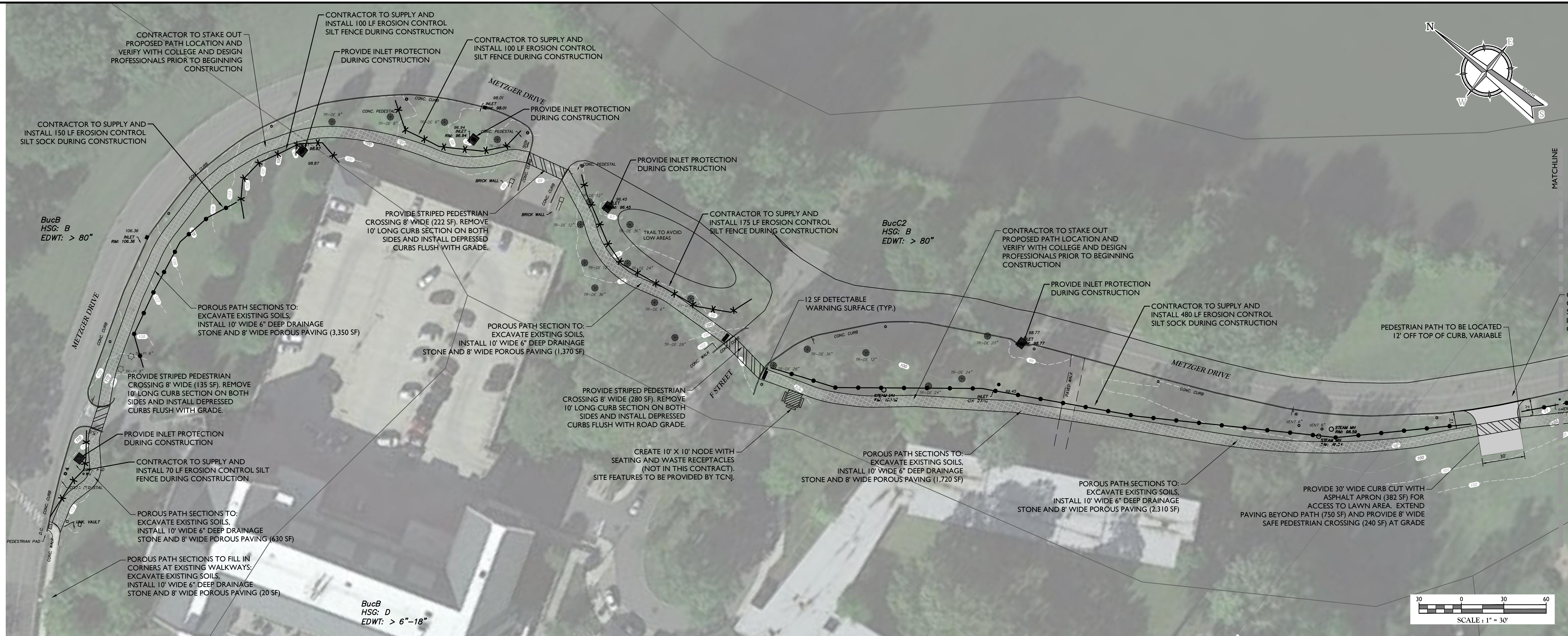

LEGEND table defining symbols for existing and proposed features such as traverse lines, property lines, curbs, sidewalks, fences, and ADA accessible stalls.

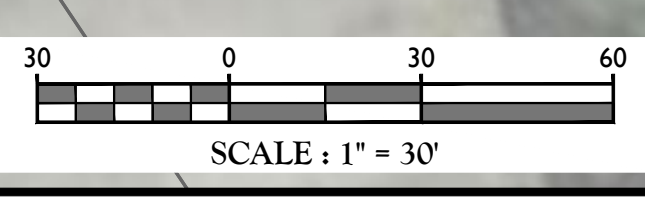



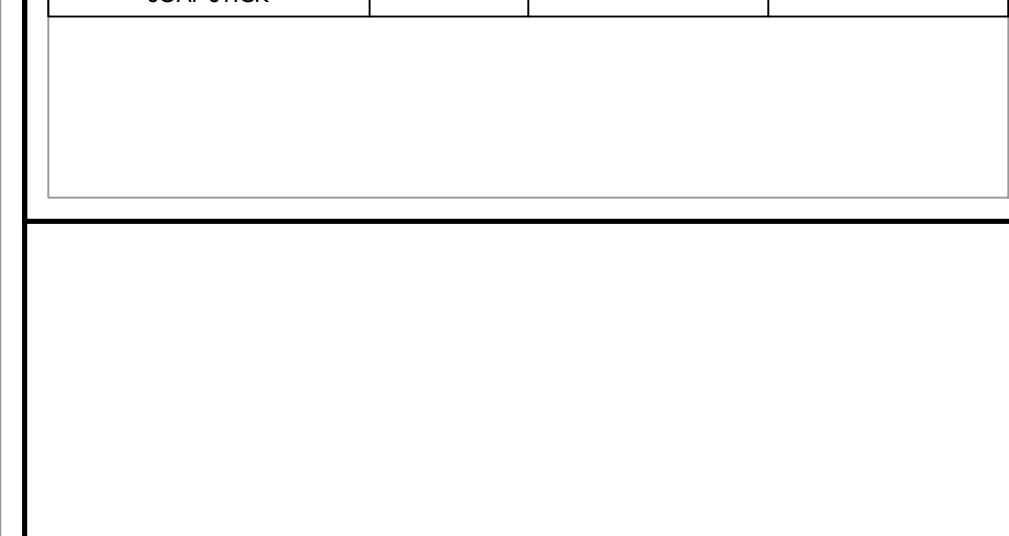
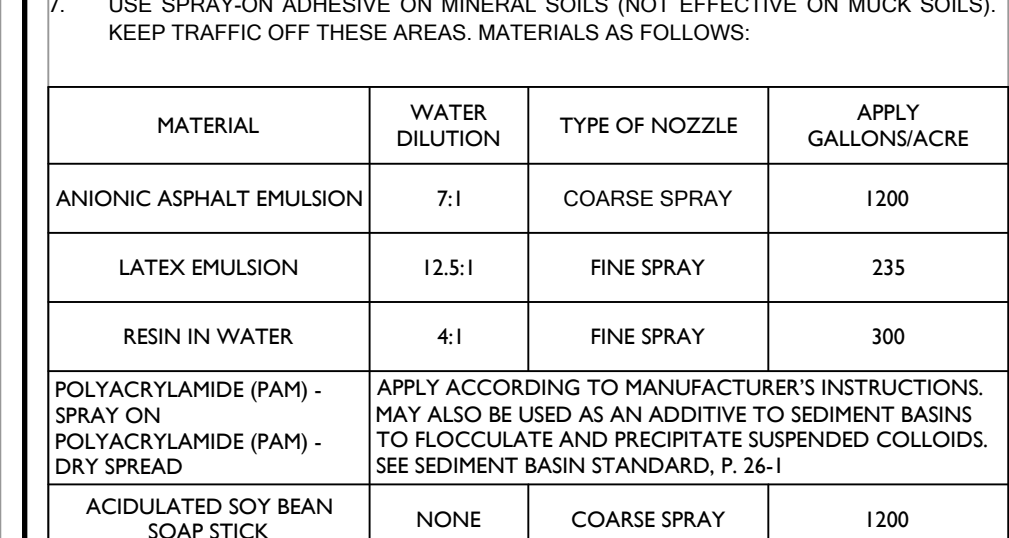
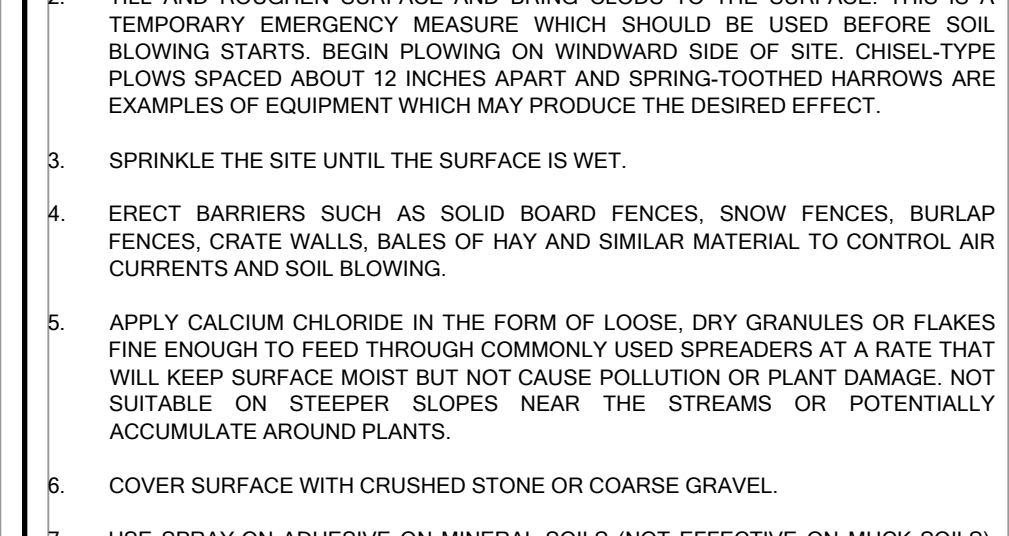
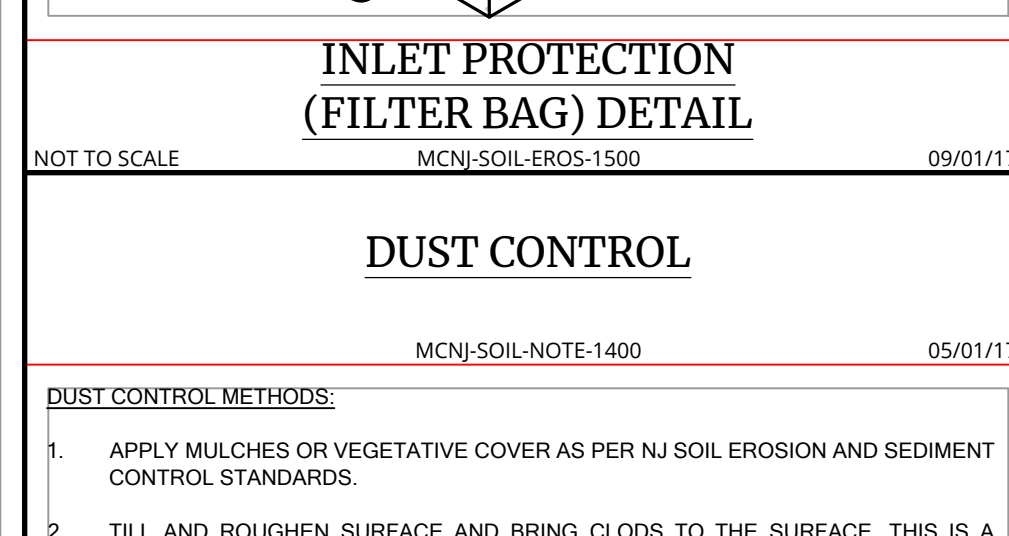
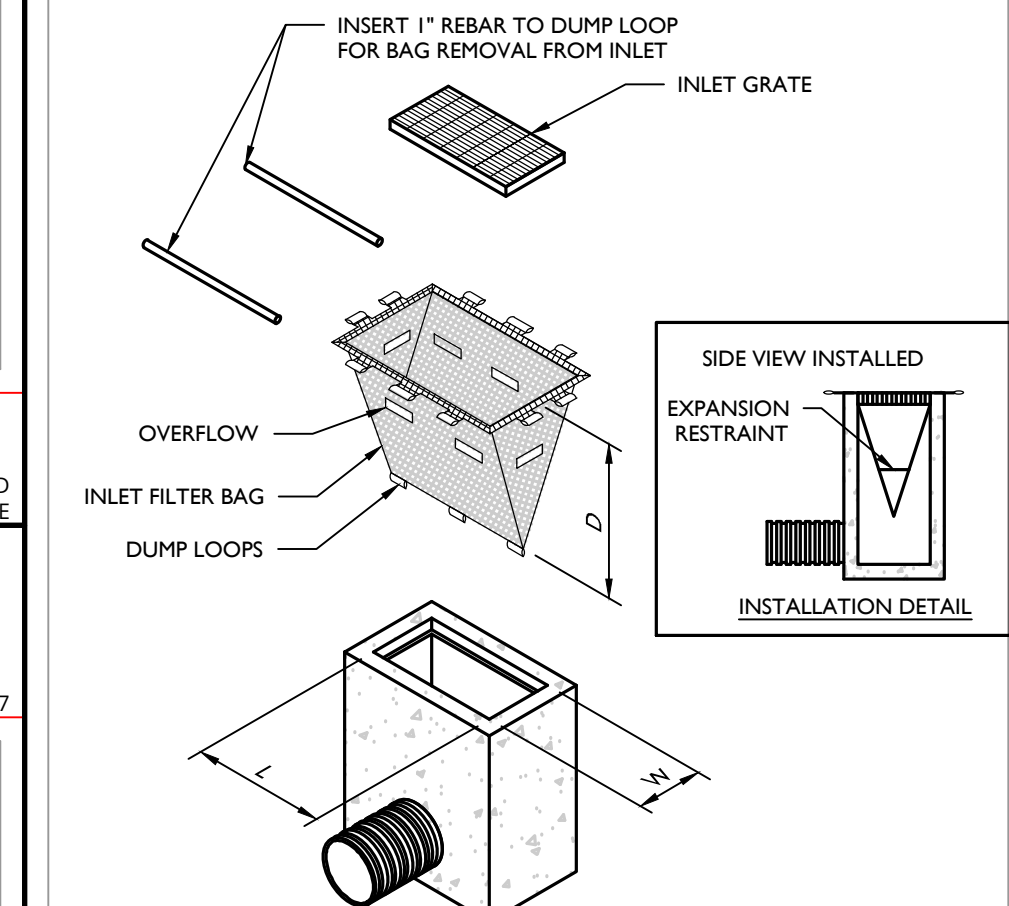
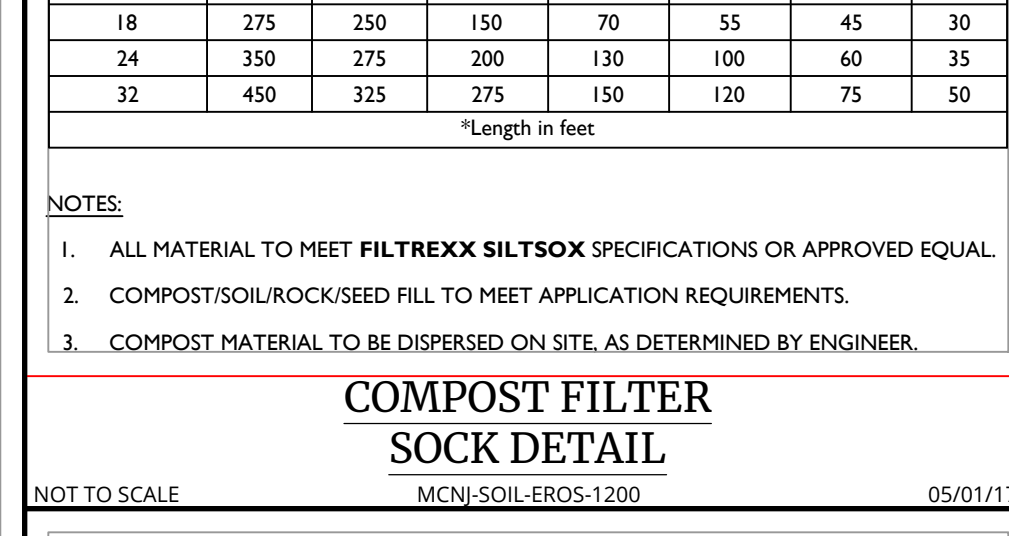
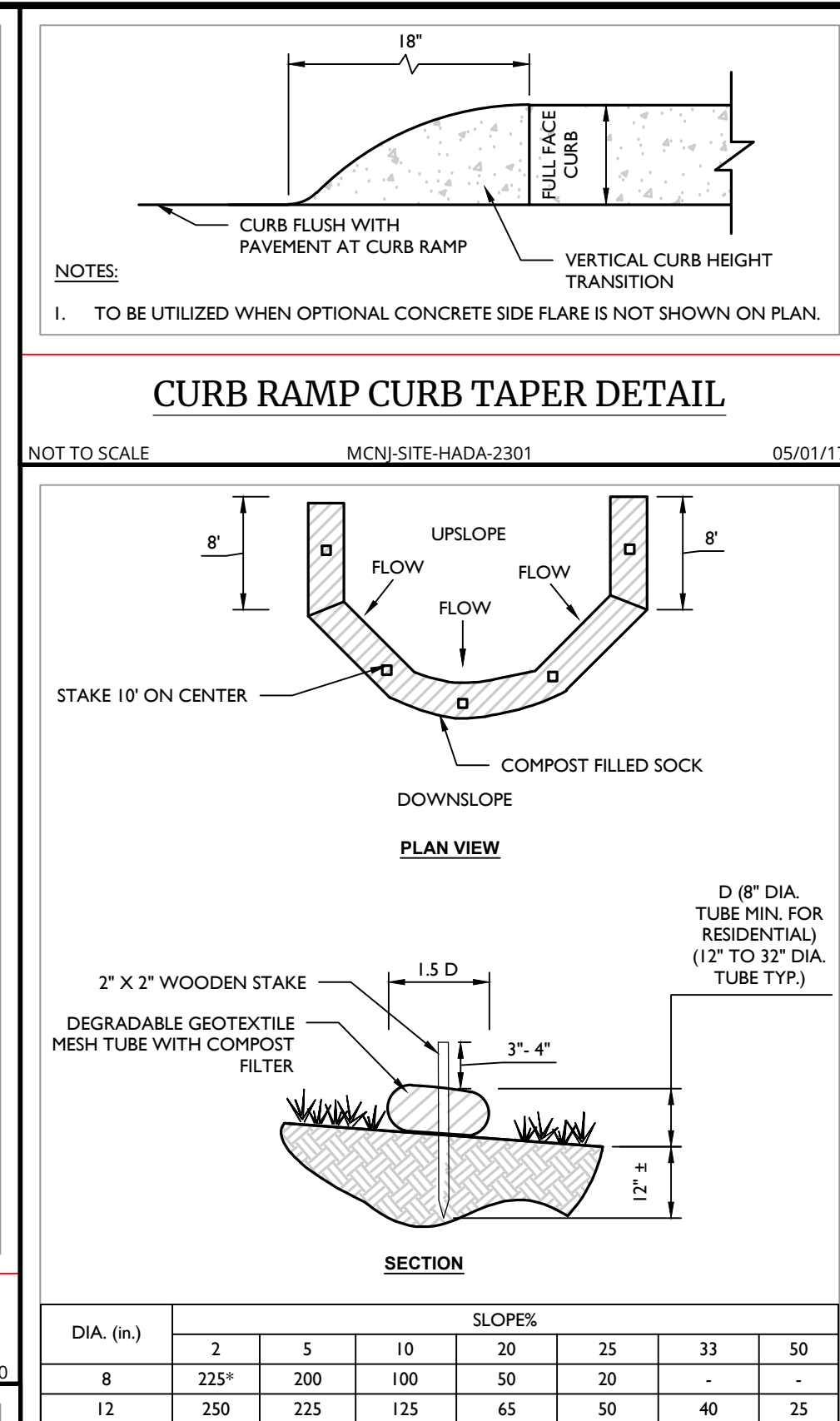
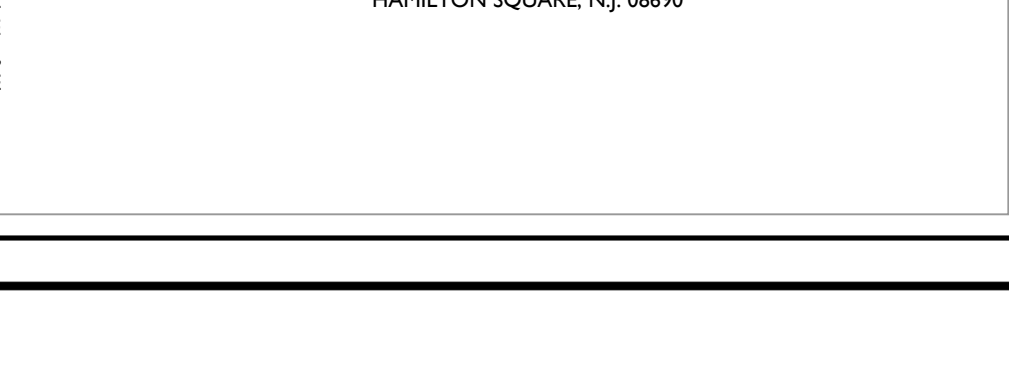
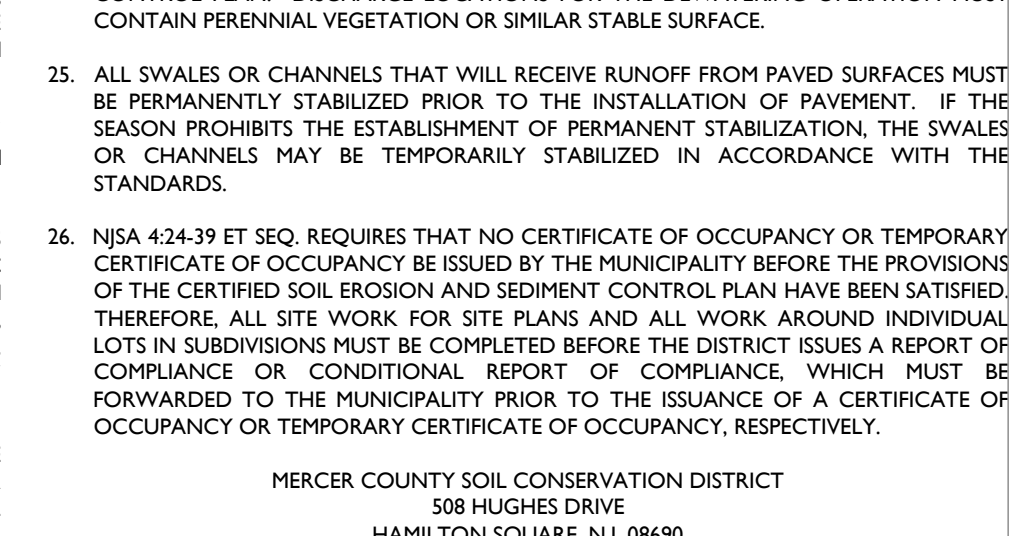
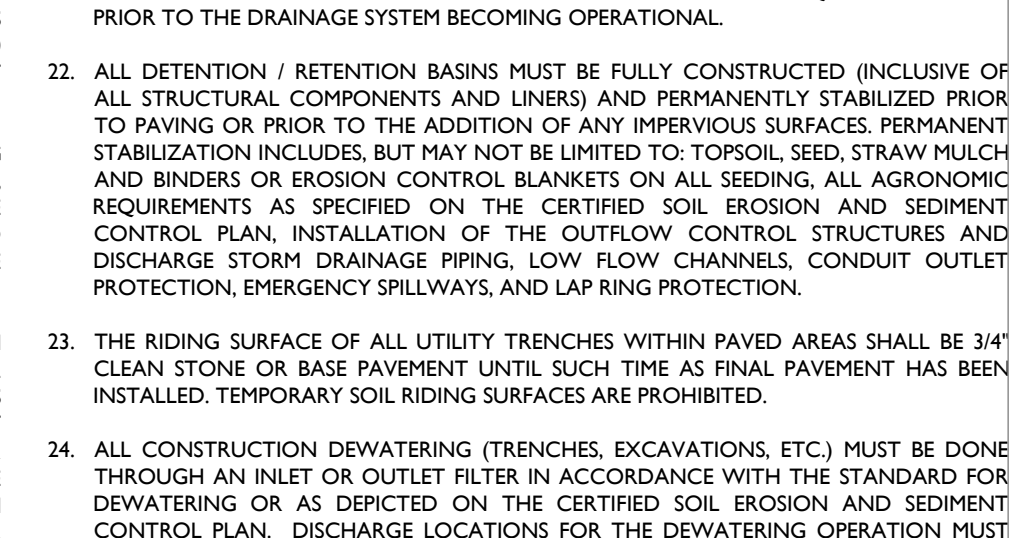
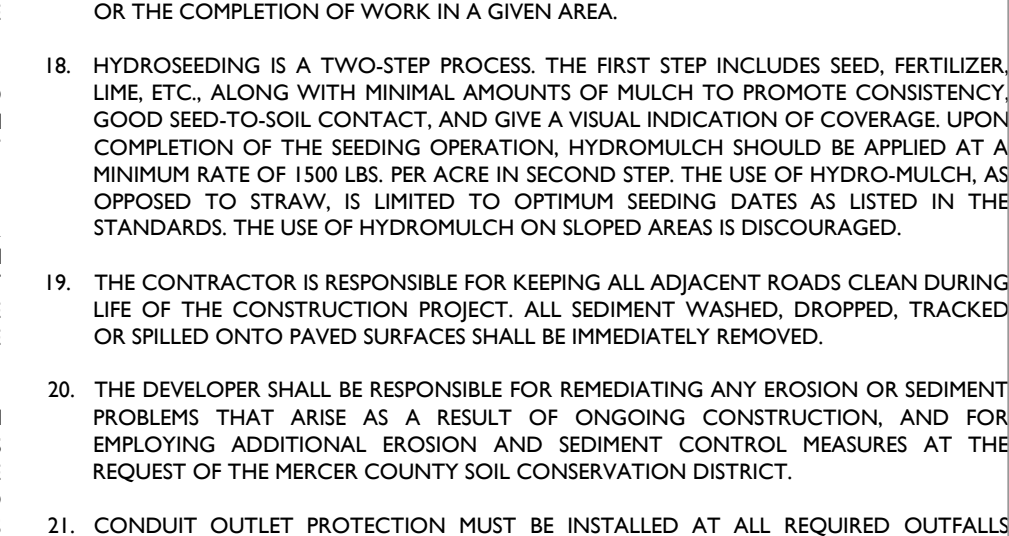
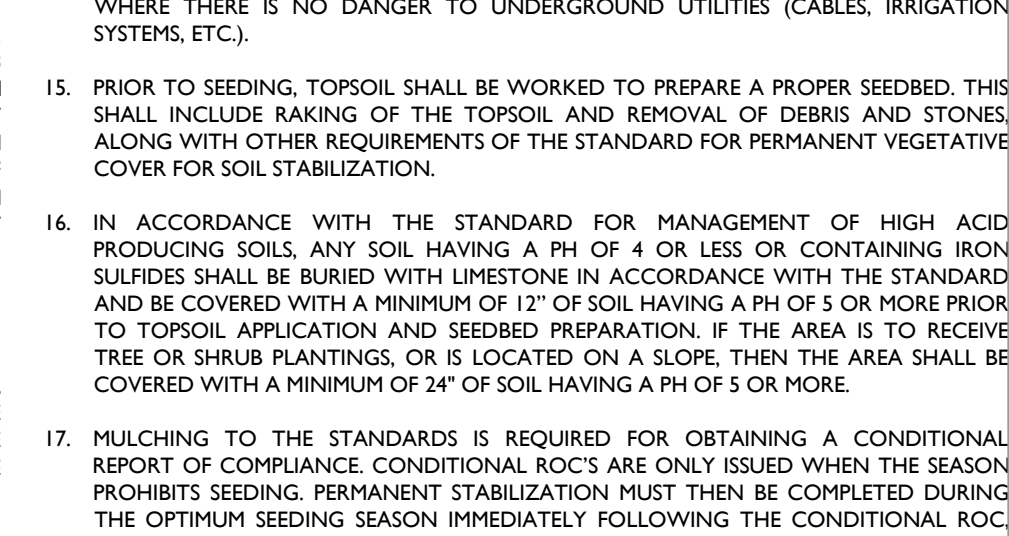
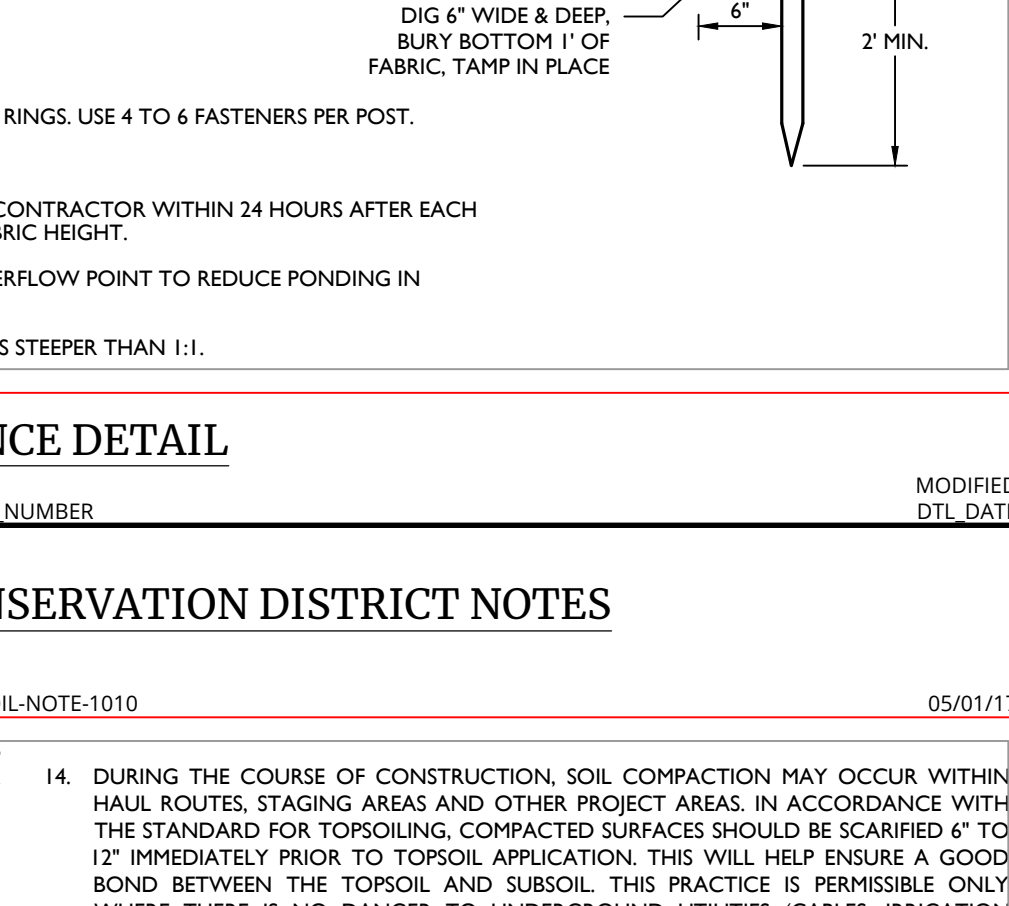
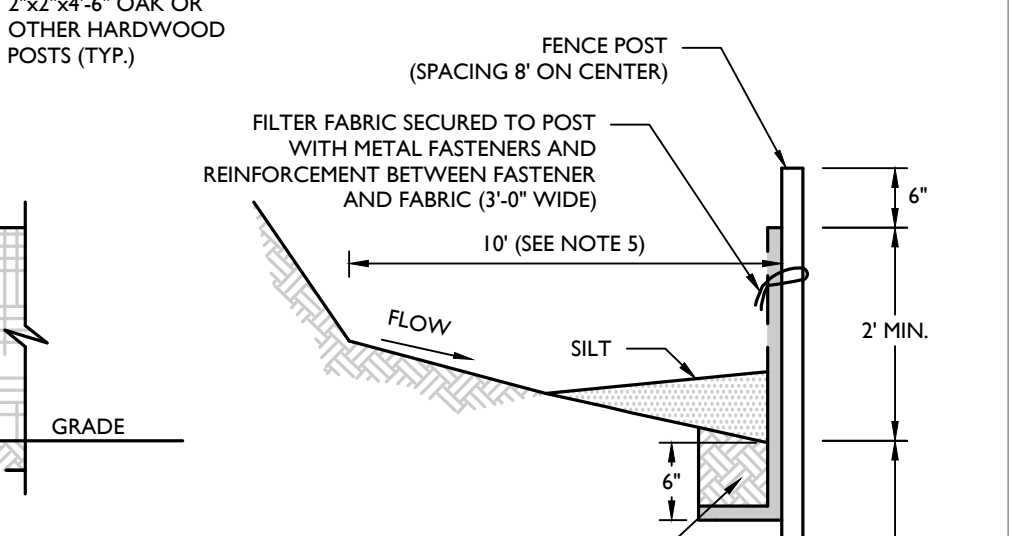
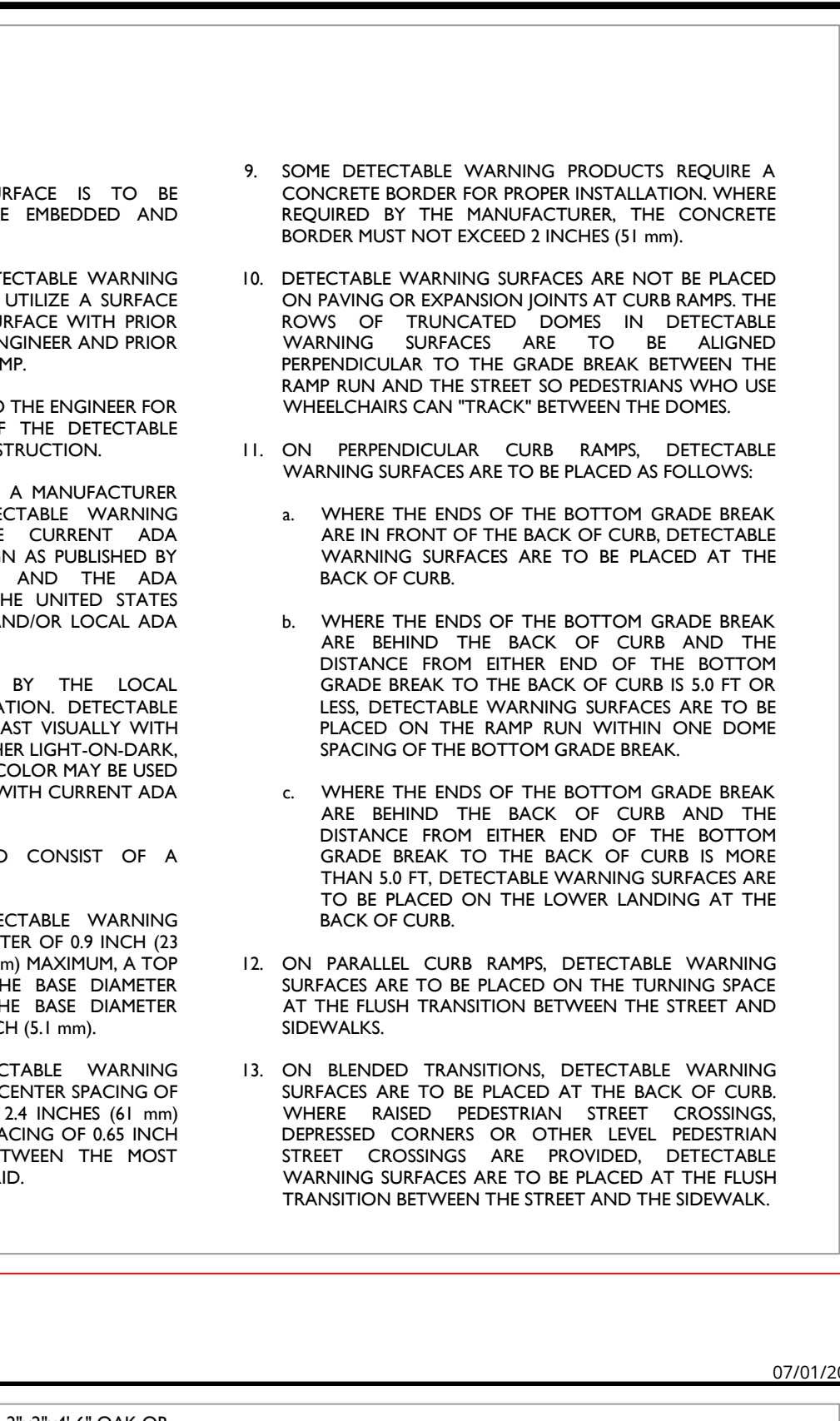
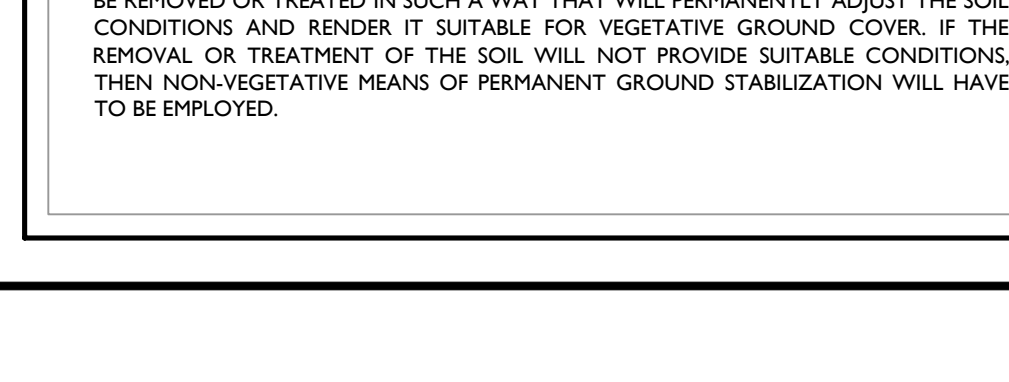
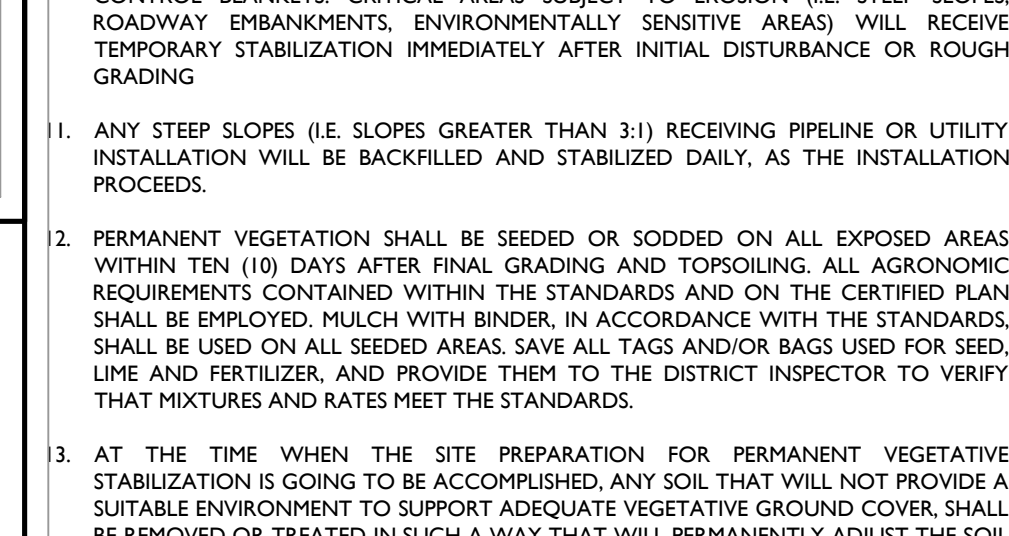
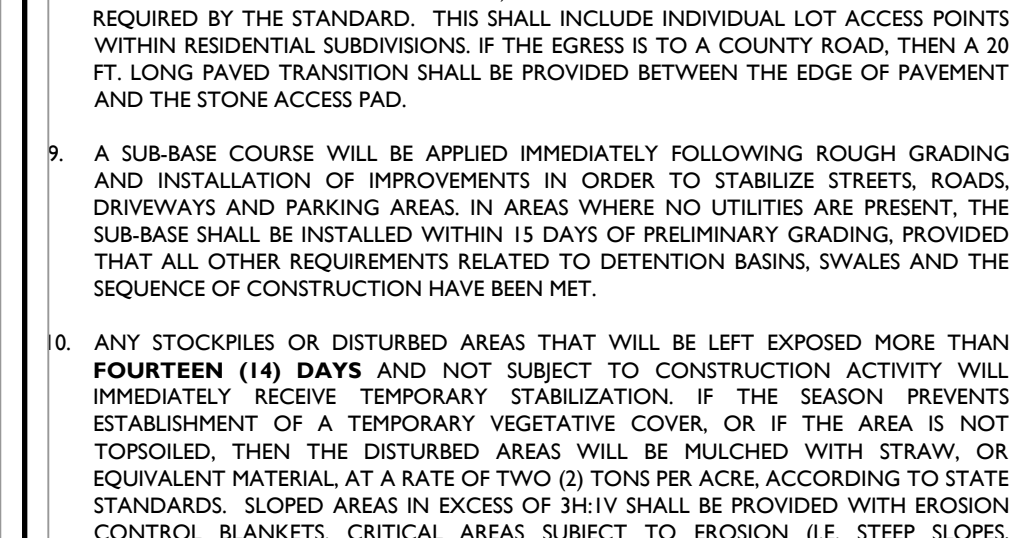
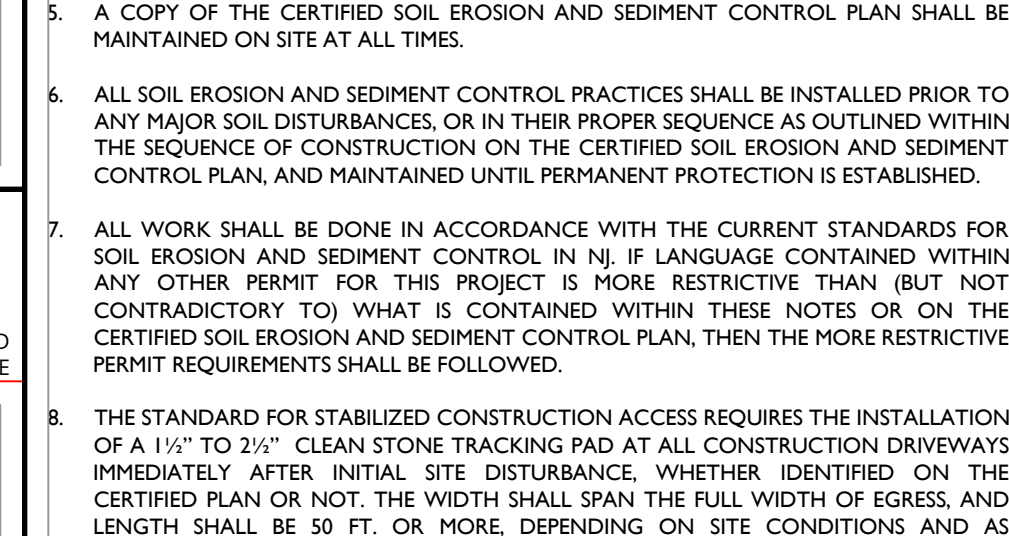
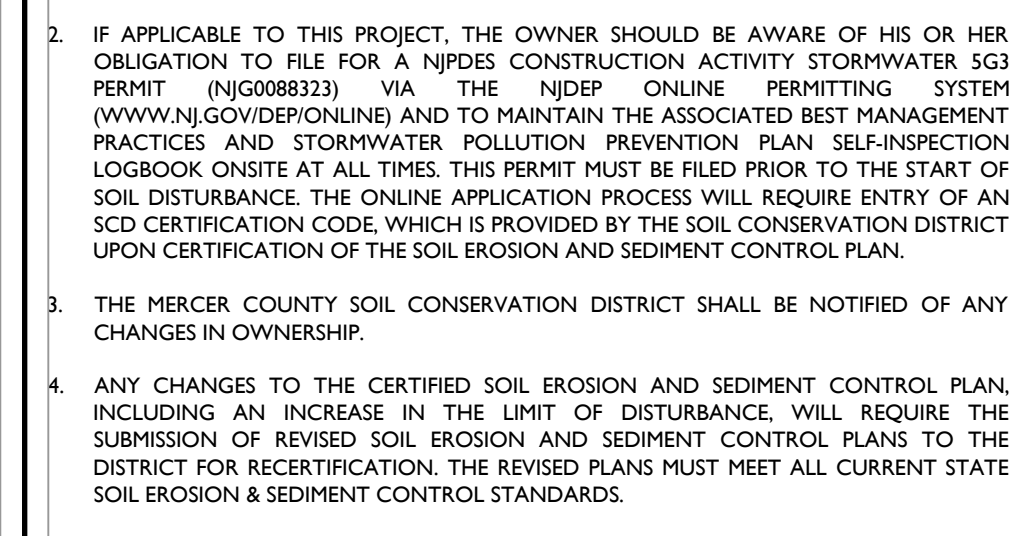
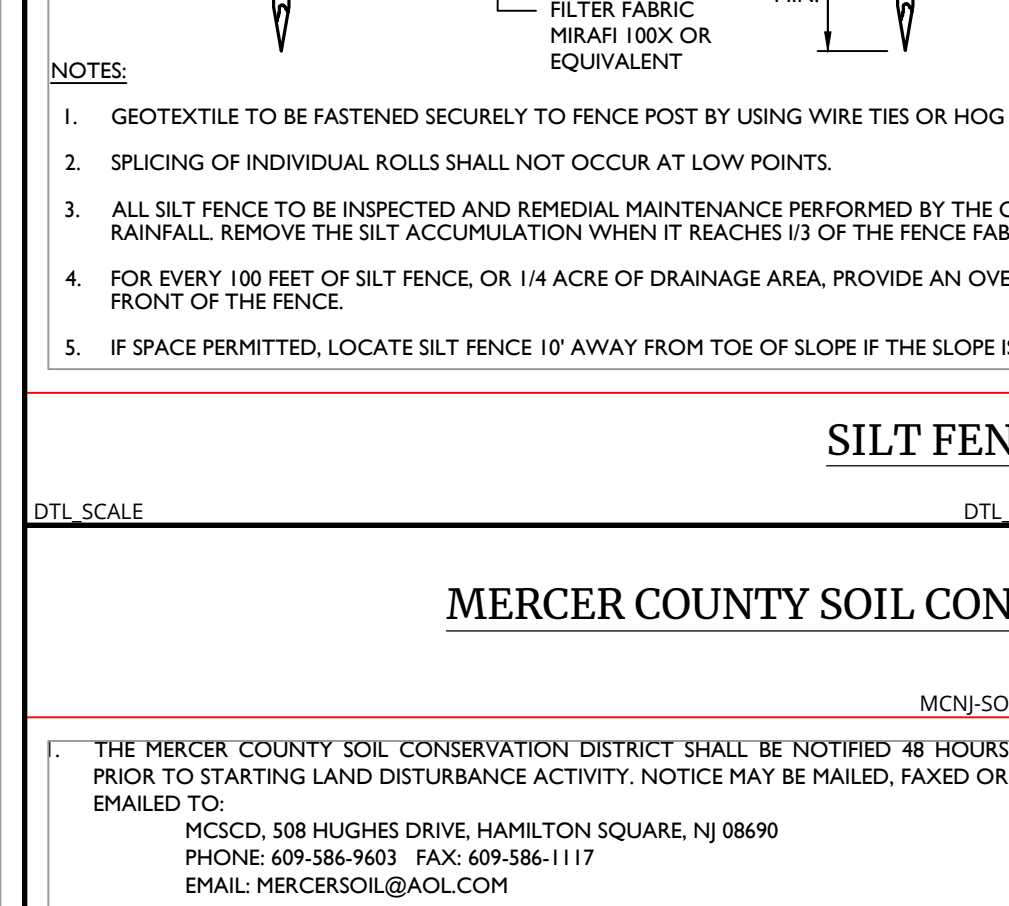
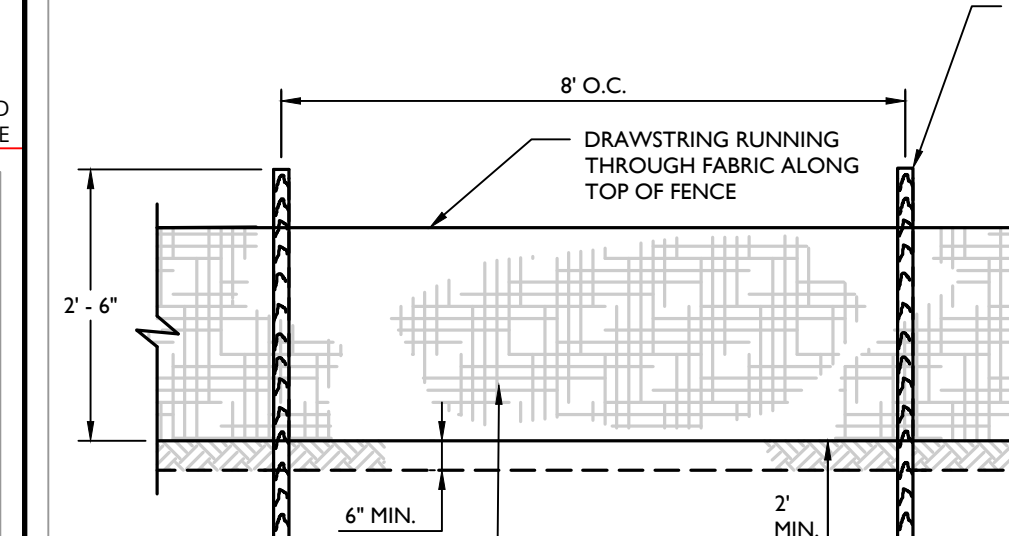
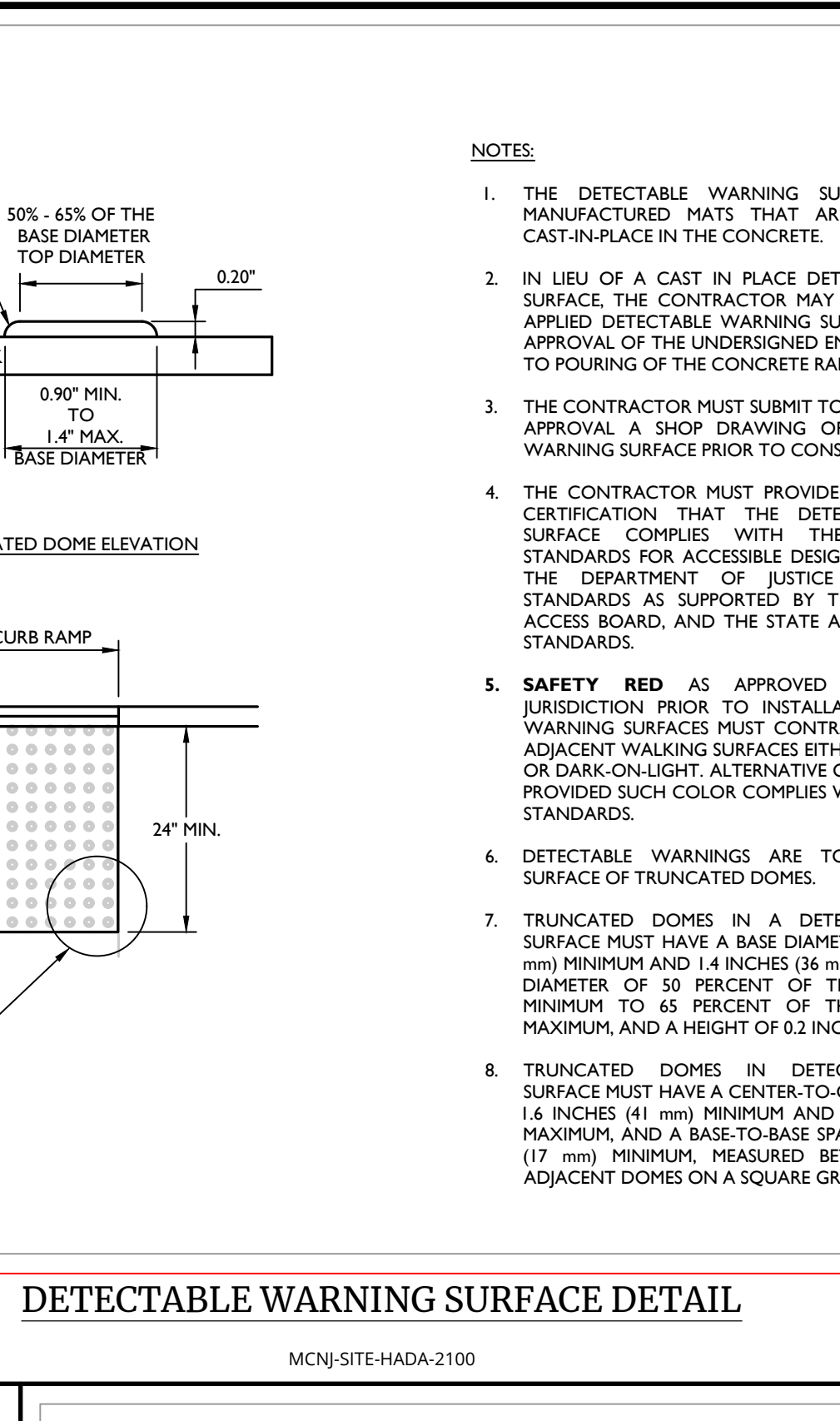
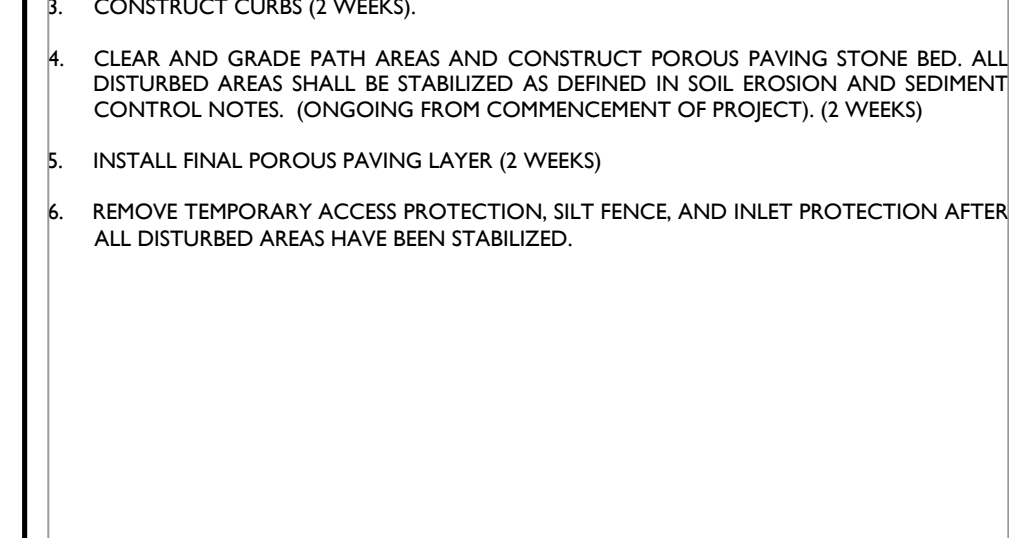
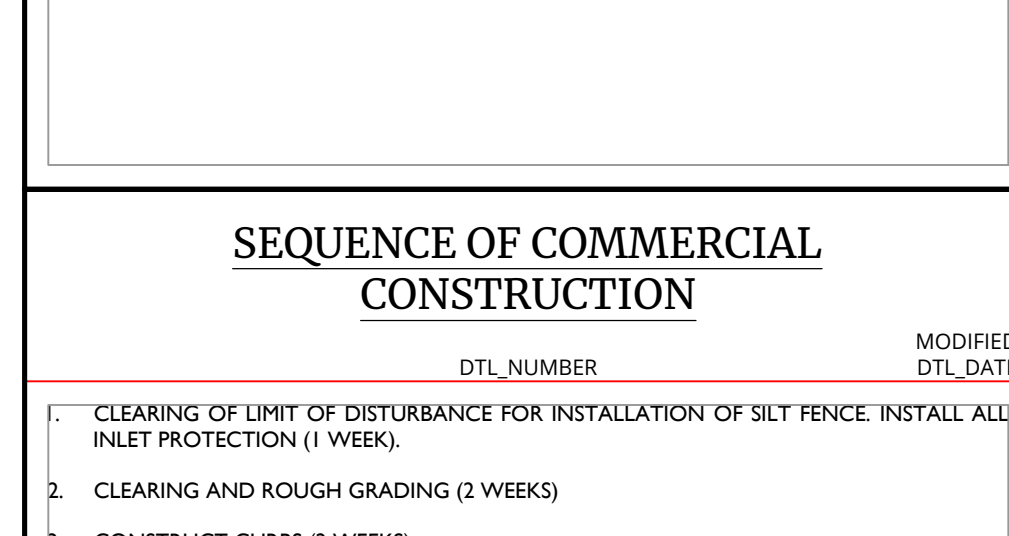
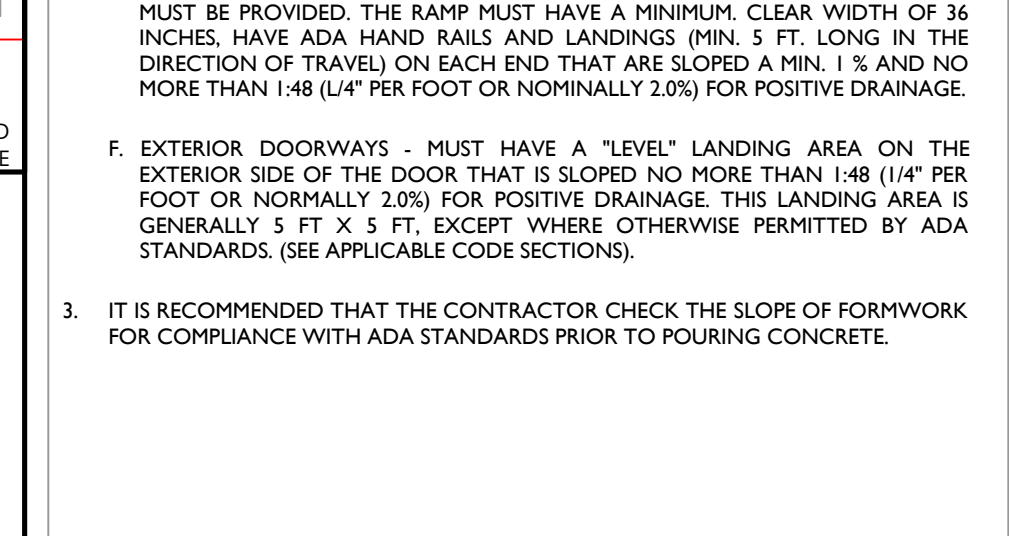
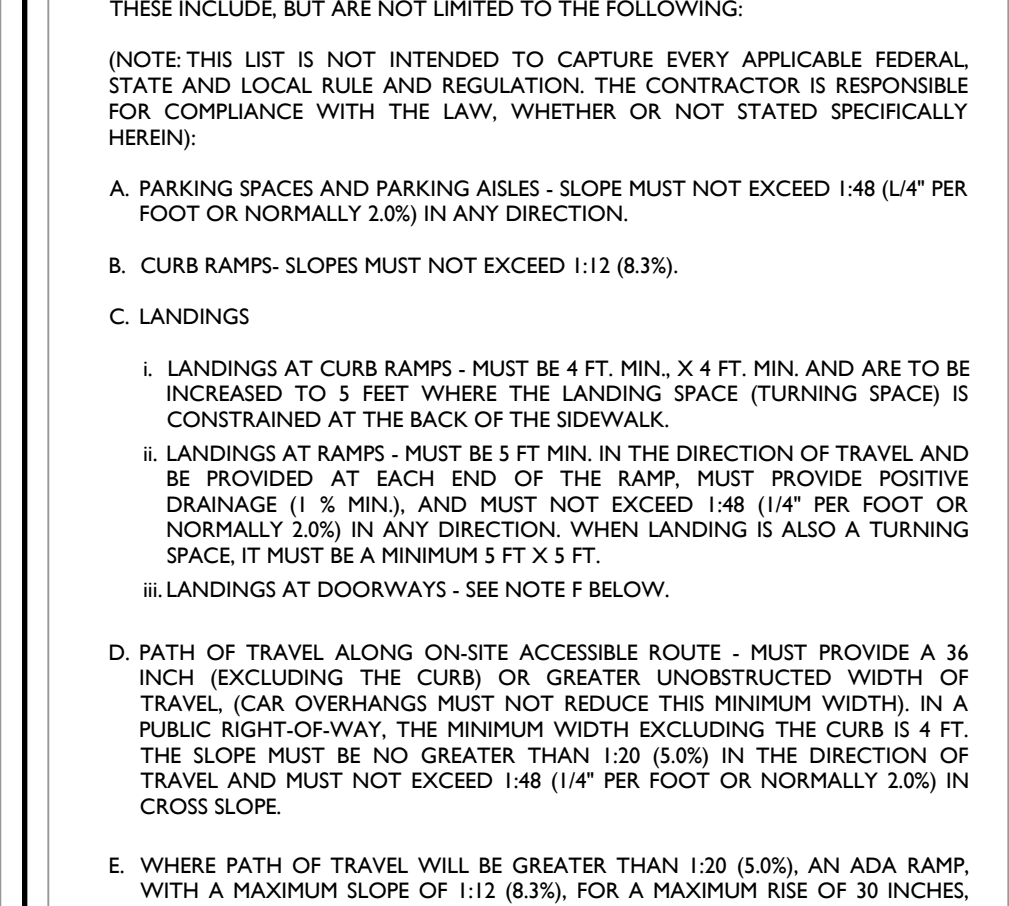
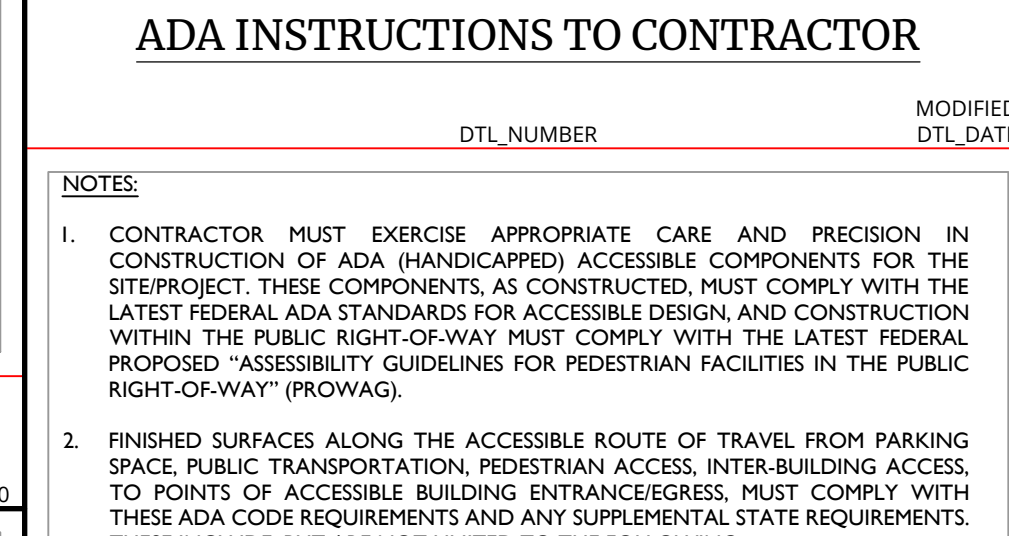
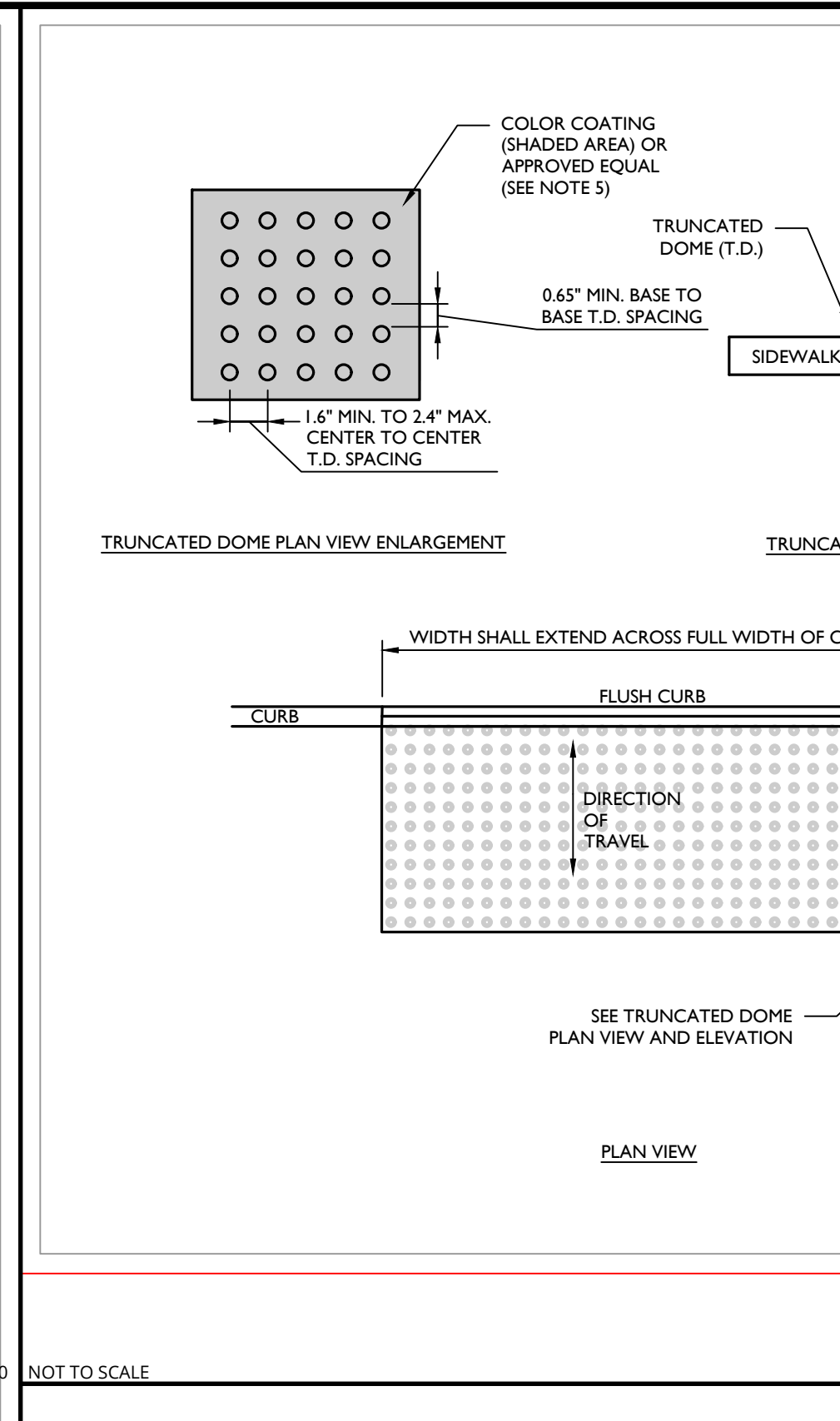
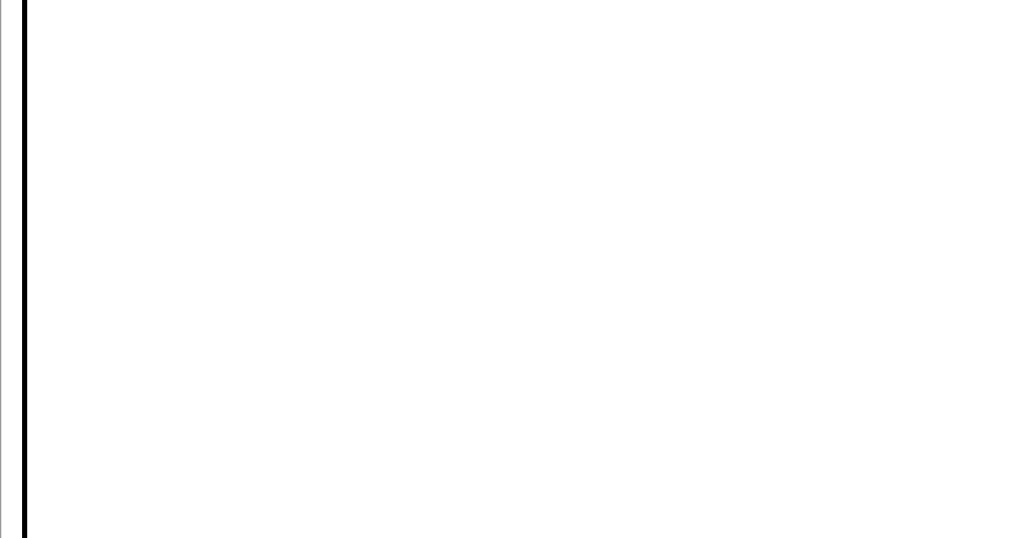
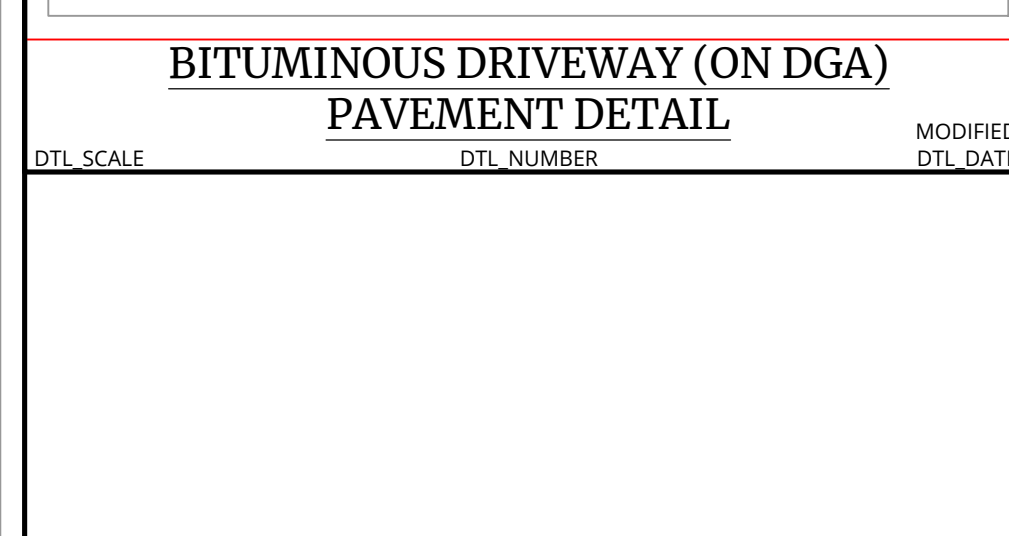
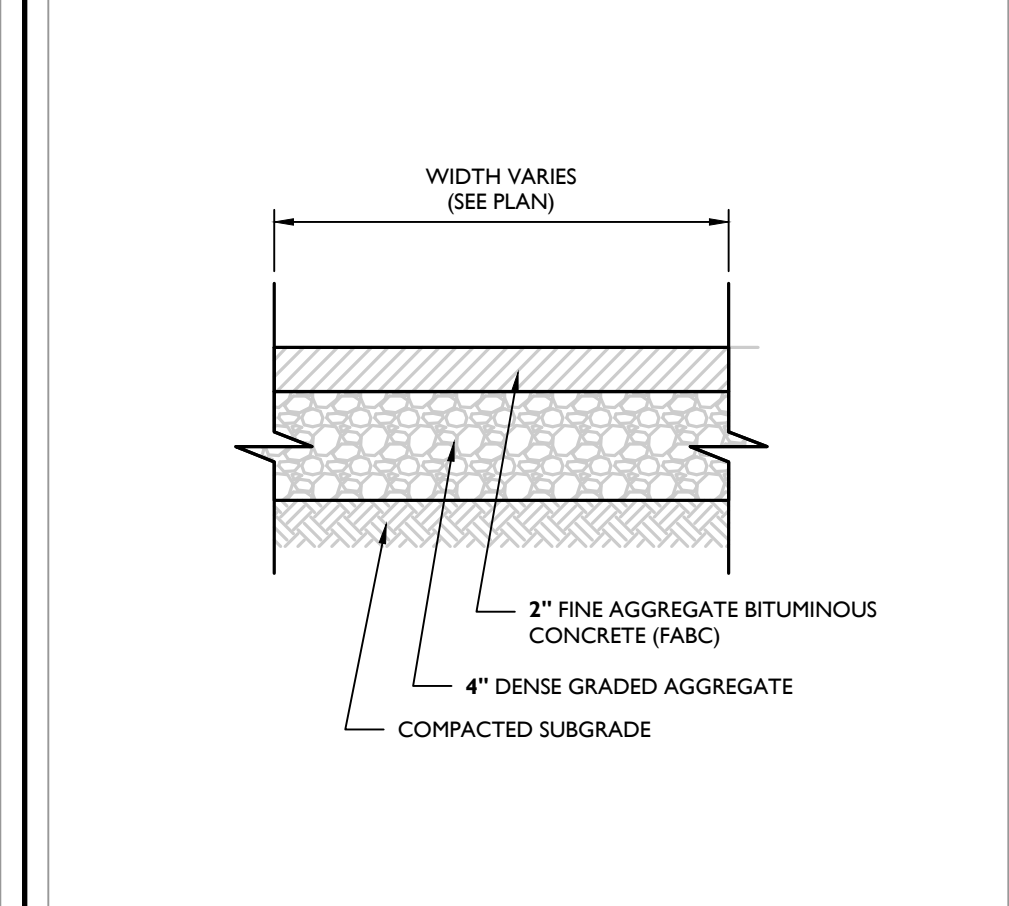
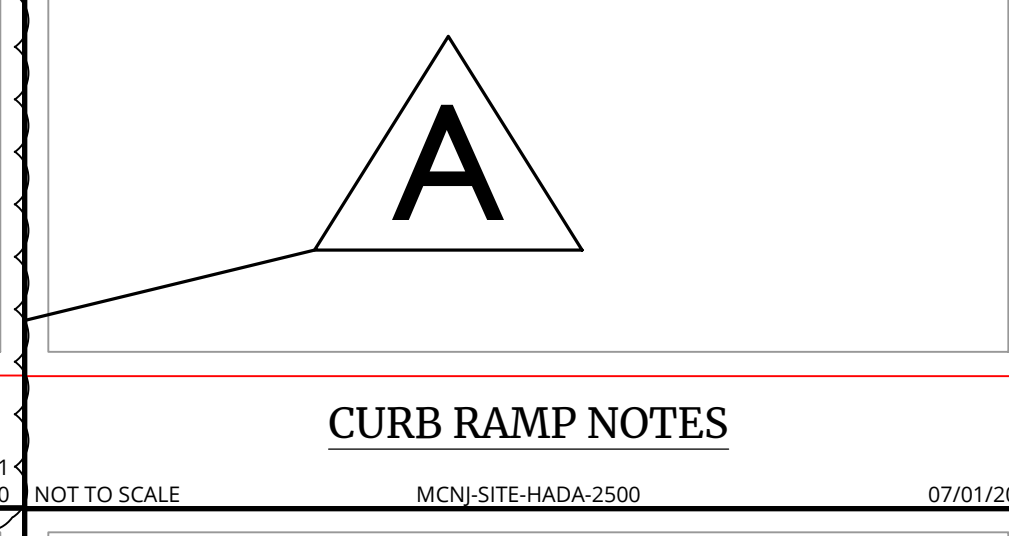
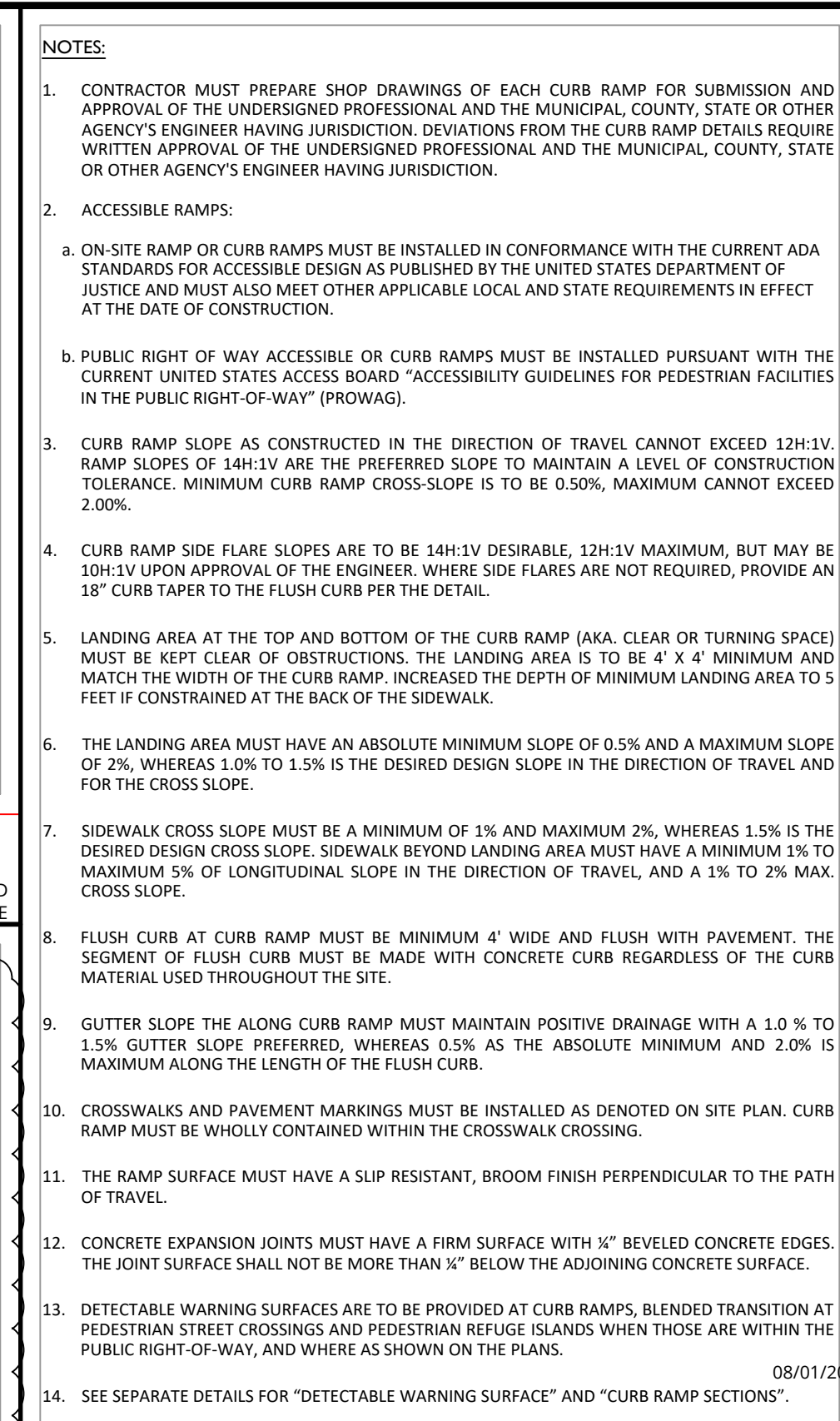
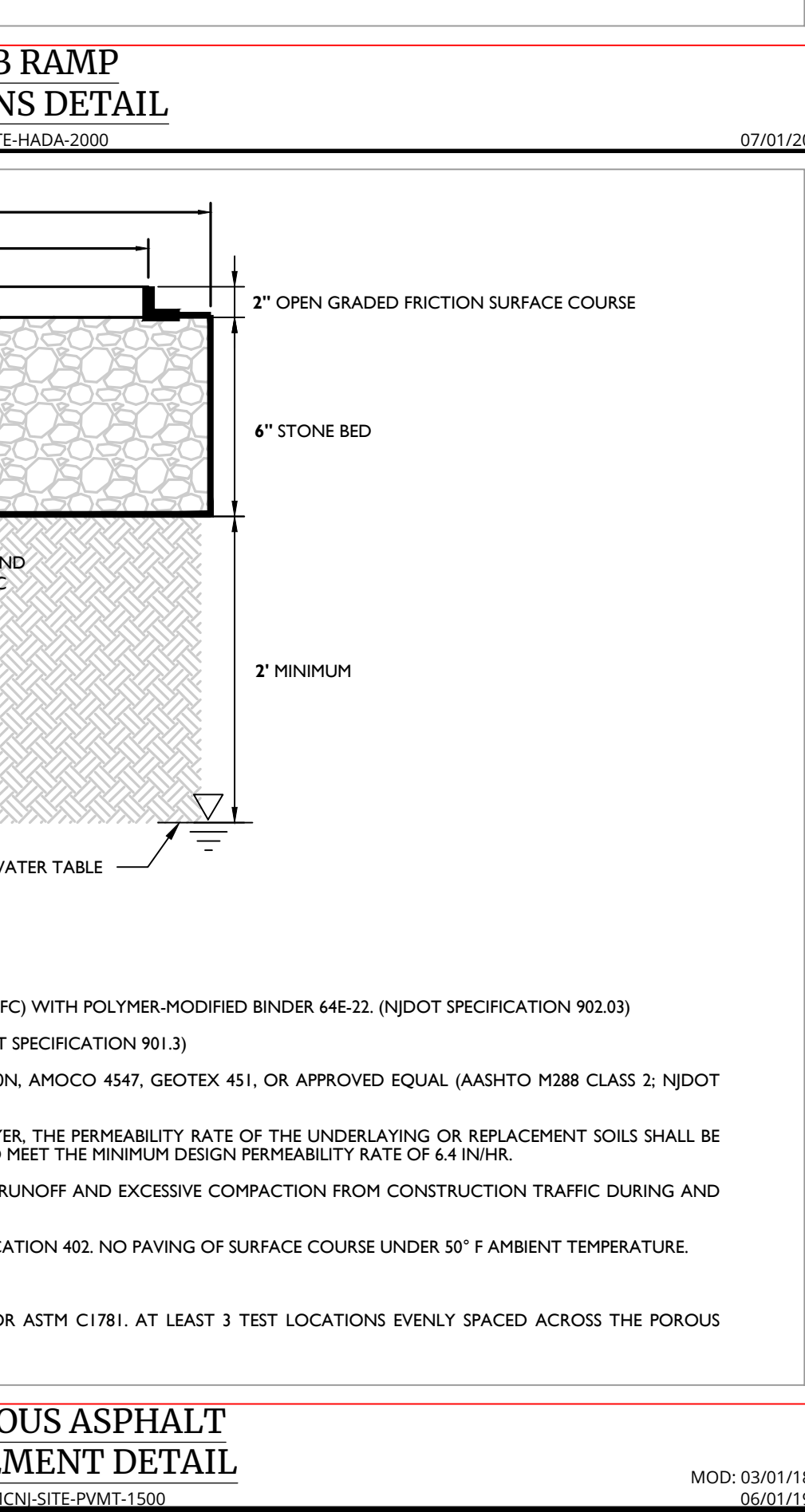
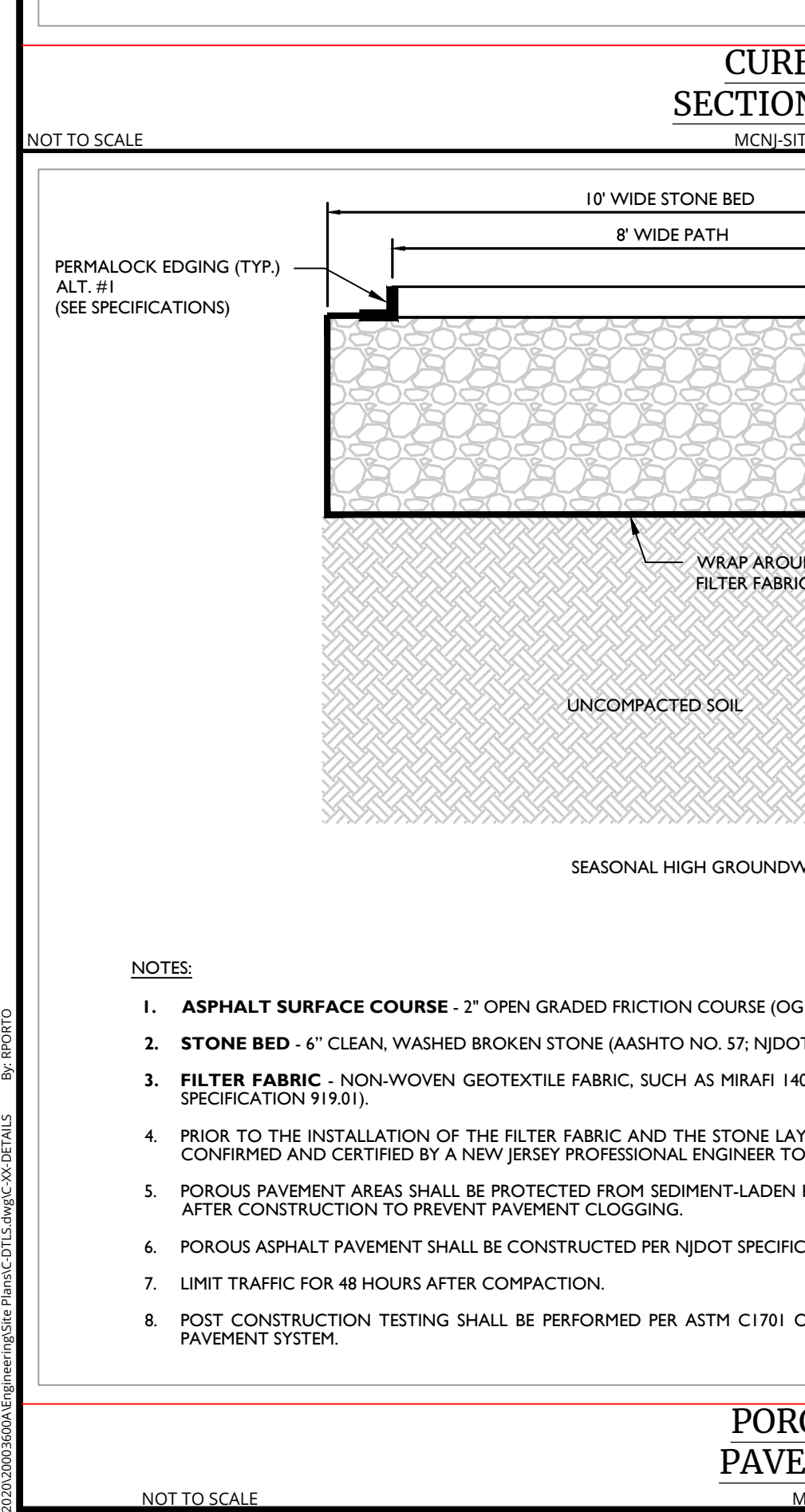
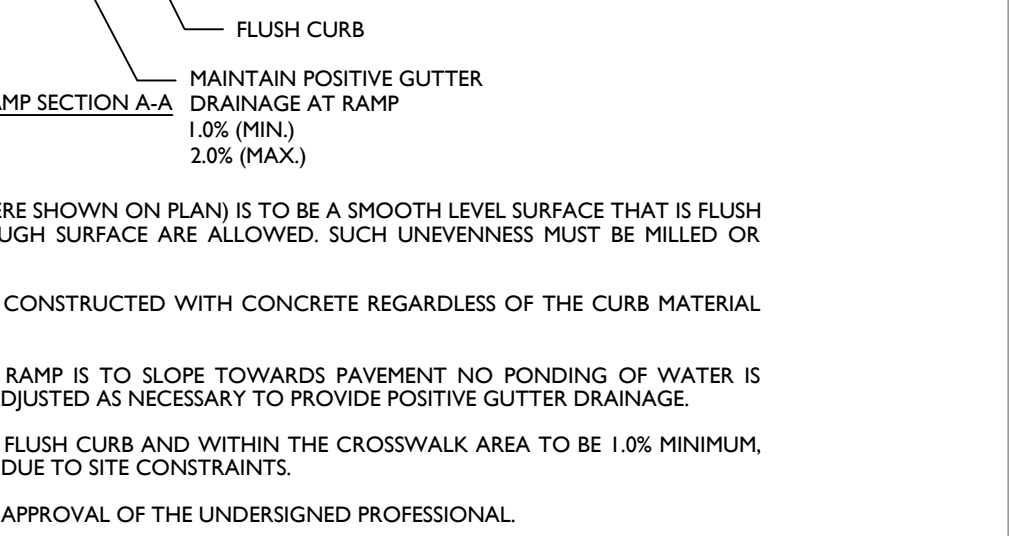
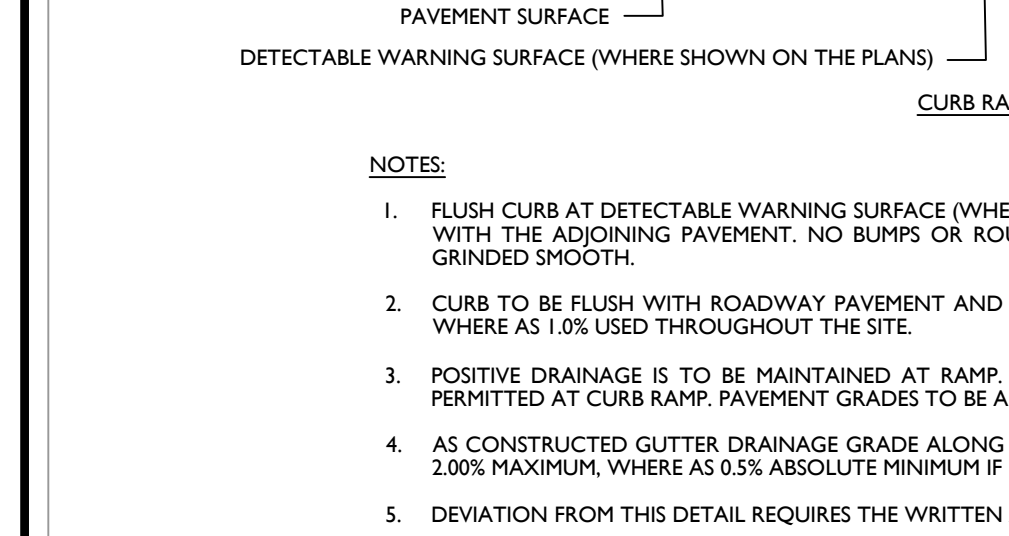
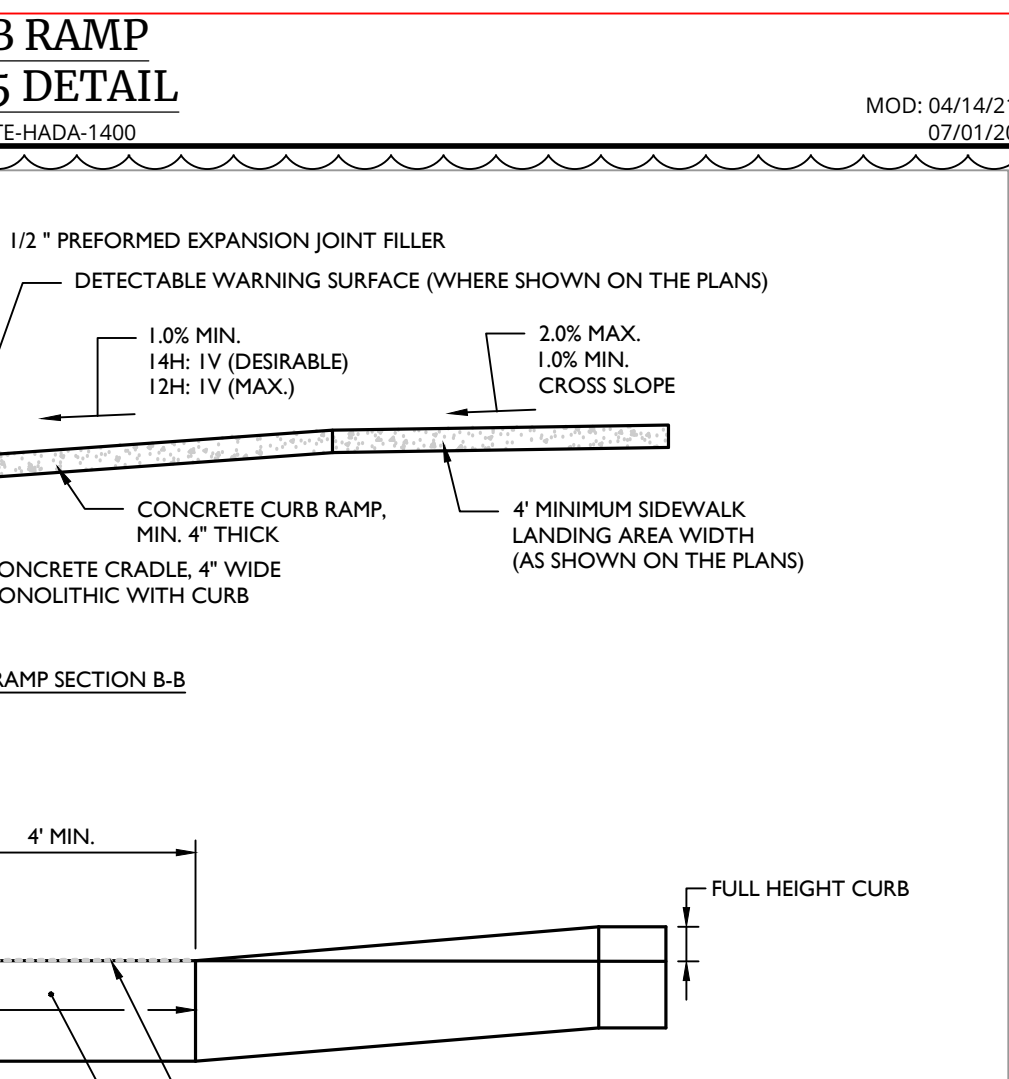
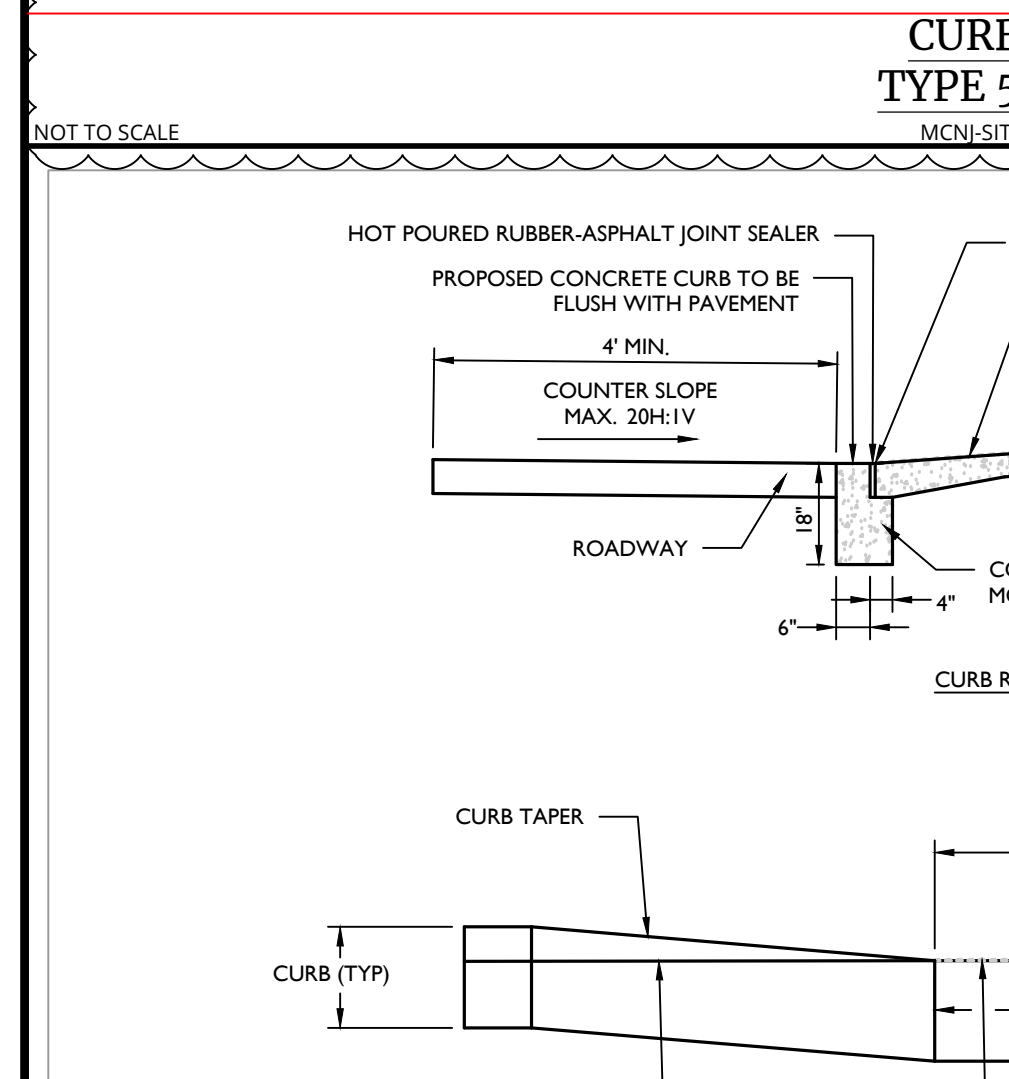
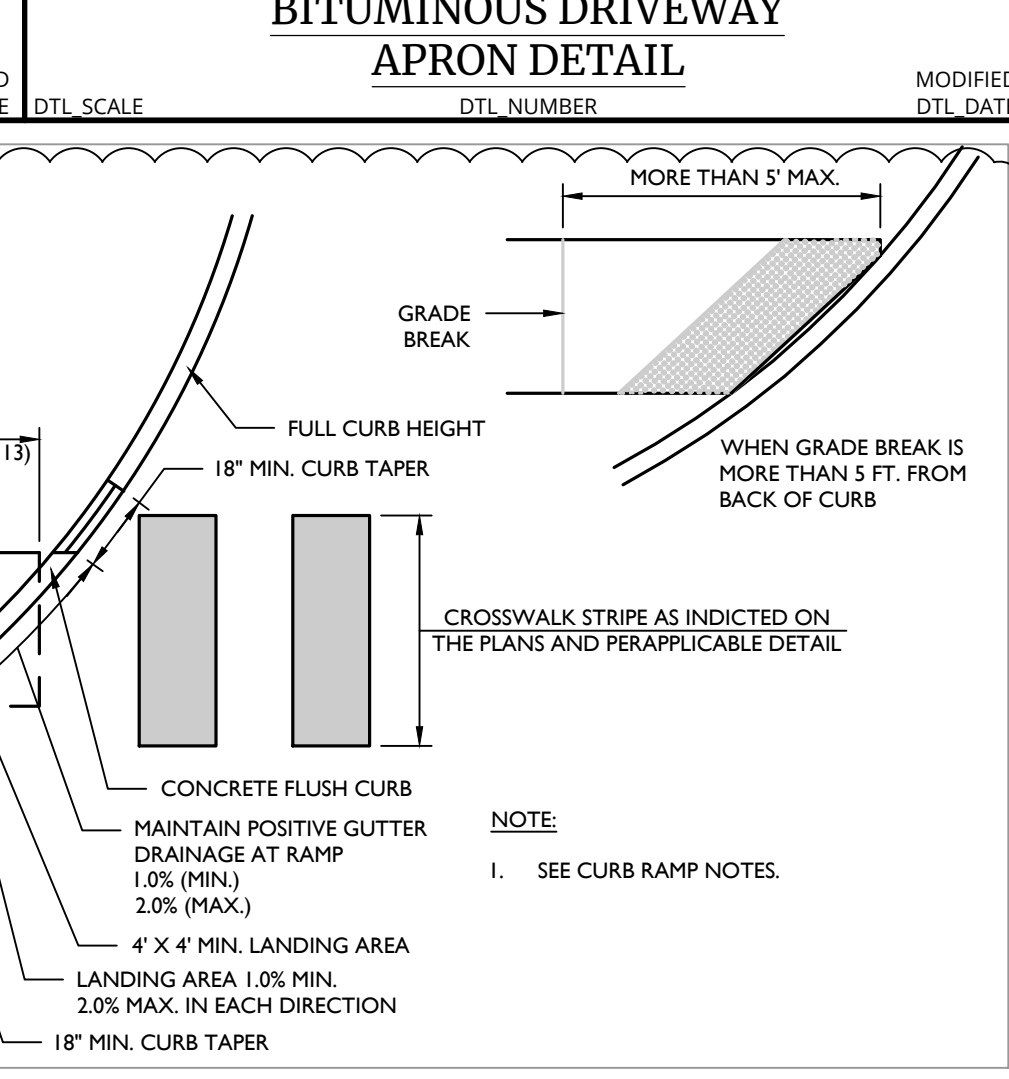
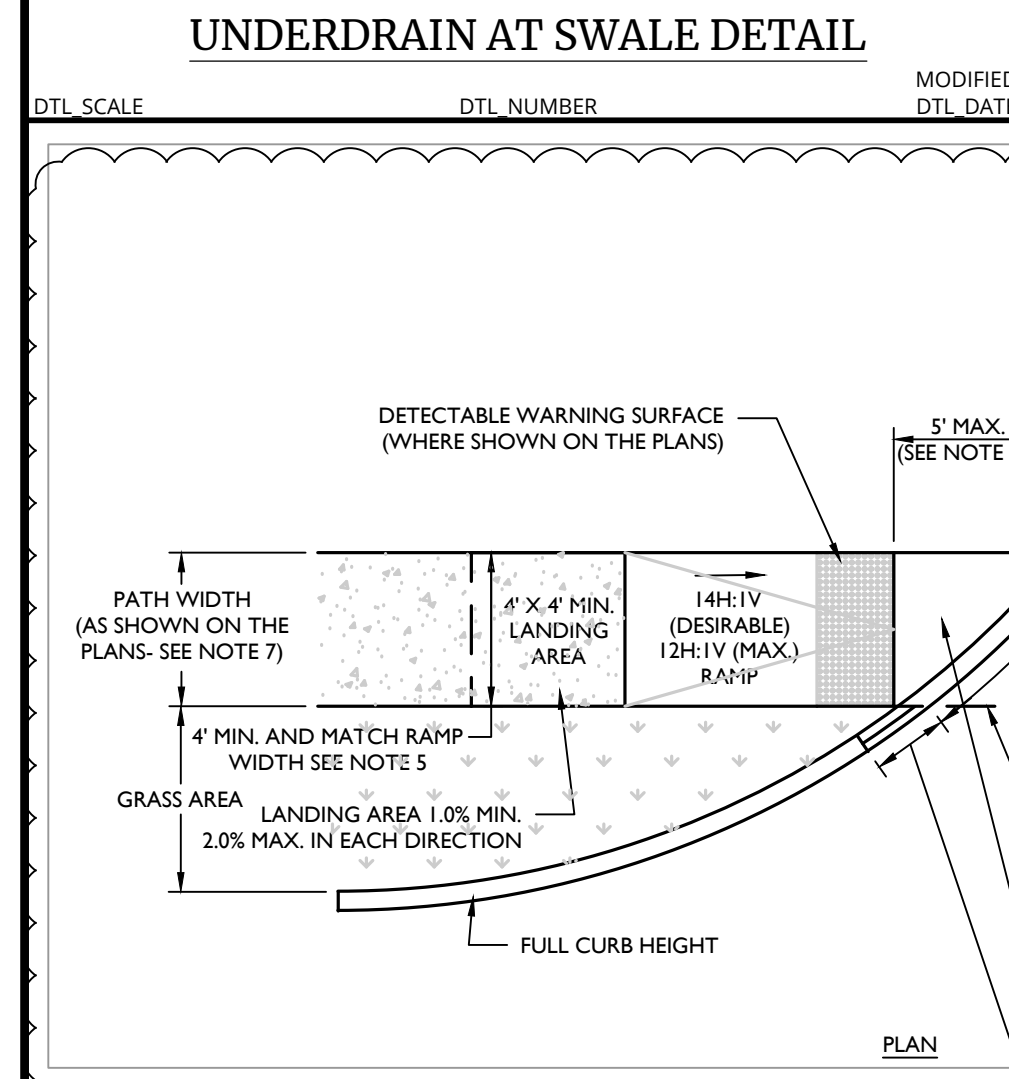
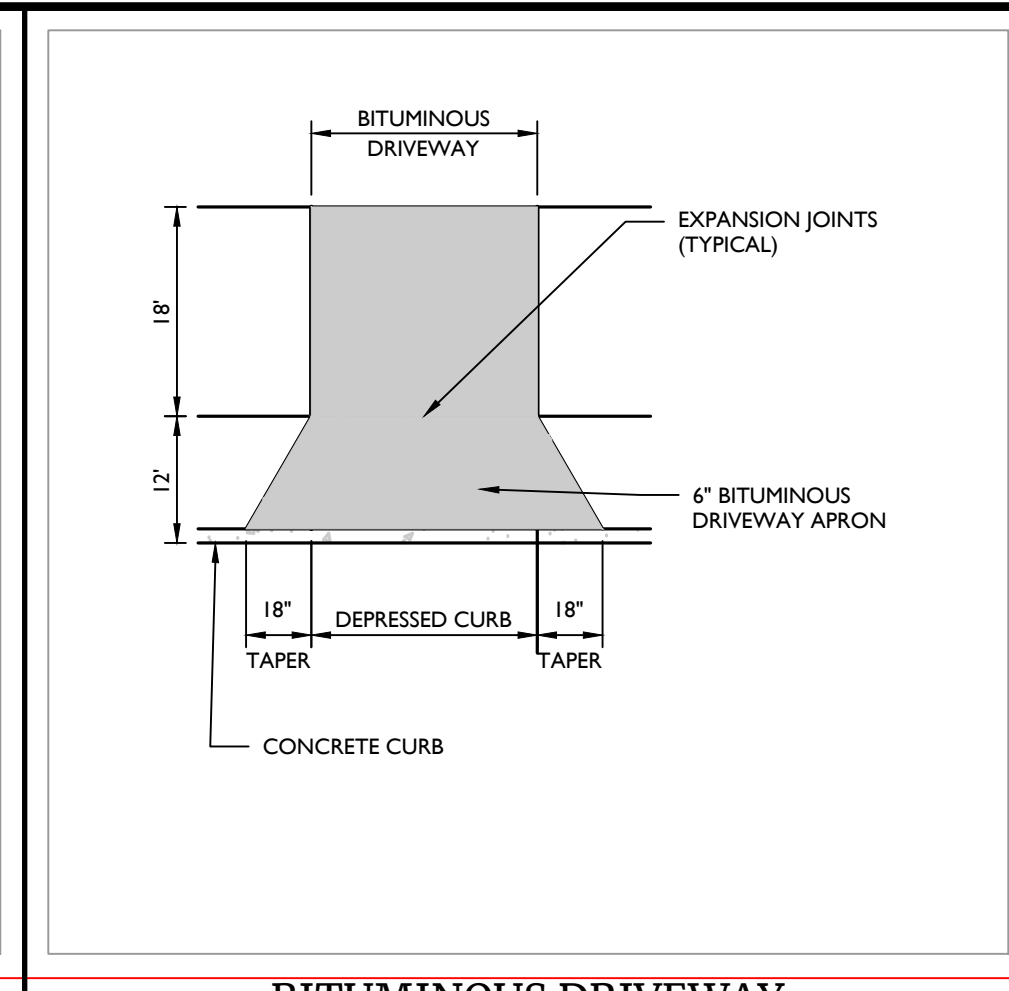
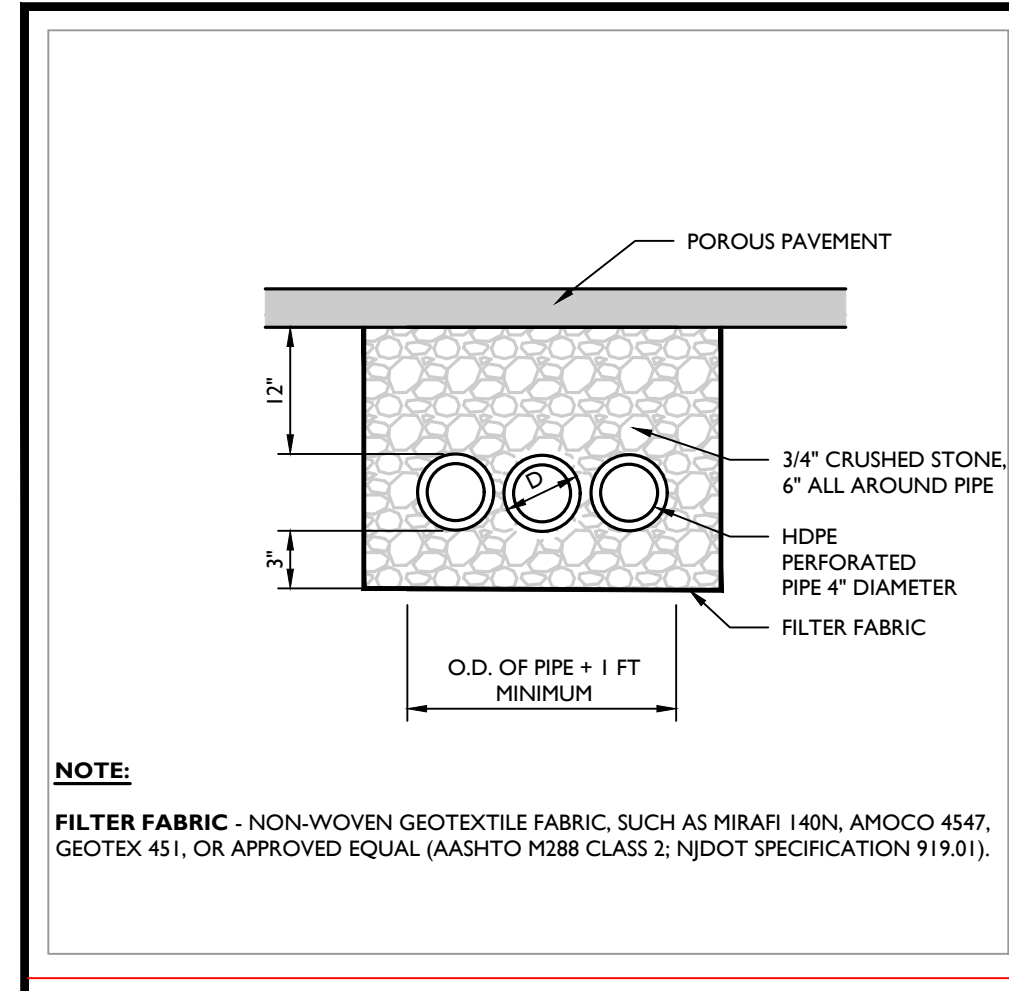

**Colliers Engineering & Design**

www.colliersengineering.com

Doing Business as **MASER**

**811** PROTECT YOURSELF

Know what's below. Call before you dig. FOR STATE SPECIFIC DIRECT PHONE NUMBERS VISIT: WWW.CALL811.COM

**Gerald DeFelice**  
NEW JERSEY LICENSED LANDSCAPE ARCHITECT  
LICENSE NUMBER: A50575  
COLLIERS ENGINEERING & DESIGN, INC.  
N.J. C.O.A.#: 2462796650

**SITE PLAN**

FOR THE COLLEGE OF NEW JERSEY

BLOCK 215 LOT 38

EWING TOWNSHIP MERCER COUNTY NEW JERSEY

**Colliers Engineering & Design**

2000 MARGENTOWN DRIVE, SUITE 100, MT. LAUREL, NJ 08054  
PHONE: 856-797-0412  
COLLIERS ENGINEERING & DESIGN, INC.  
DOING BUSINESS AS MASER CONSULTING

SCALE: AS SHOWN DATE: 04/14/21 DRAWN BY: RFP CHECKED BY: GD  
PROJECT NUMBER: 20002600A DRAWING NAME: C-0115

SHEET TITLE: CONSTRUCTION DETAILS

SHEET NUMBER: 05 OF 05

NOTE: DO NOT SCALE DRAWINGS FOR CONSTRUCTION.