



**To: All Vendors Bidding on The College of New Jersey
Pool Repairs Packer Hall Aquatic Center**

From: The College of New Jersey

Date: May 28, 2020

ADDENDUM NO. 1

ISSUE DATE: May 28, 2020

**REFERENCE: The College of New Jersey
AB200034-RFP-Pool Repairs Packer Hall Aquatic Center**

Date of Original Bidding Documents: May 12, 2020

INTENT: This Addendum forms a part of the Contract Documents and modifies the original Bidding Documents and Prior Addenda if any, as identified above. Acknowledge receipt of this Addendum in the space provided on the Bid Form. Failure to do so may subject Bidder to disqualification.

VIRTUAL BID OPENING:

Under the provisions of the State College Contracts Law, Chapter 64 of Title 18-A, The College of New Jersey is notifying all contractors planning on submitting proposals for the **New Residence Hall Mold Remediation and Restoration Project (AB200029)** that due to COVID-19, an announcement is posted on The College's website at <http://bids.pages.tcnj.edu/> providing information to bidders of the bid process.

Question:

Drawing PA-301 General Repair Notes call for all existing pool tile grout joints to be removed to the full depth of tile by power tools. This is not a realistic approach nor can be achieved in a realistic time period. There will also be extensive damage to existing tile if all grout joints are grinded. Please confirm all loose grout can we removed by use of power washer and all remaining grout shall be left in place?

Answer:

All grout to be removed and replaced per design.

Milestone Schedule Revision:

Milestone Schedule was revised to extend construction period.



Drawing Revision:

Enclosed is an updated drawing #301 for the pool. We have shown many of the repair areas we found during our survey and changed the tile repair quantity. We reduced the base quantity from 1500 sq ft to 850 sq ft.

END OF ADDENDUM NO. 1



TCNJ THE COLLEGE OF
NEW JERSEY

POOL REPAIRS PACKER HALL AQUATIC CENTER

MILESTONE SCHEDULE ADDENDUM 1, 5/28/2020

Bid Released	Sun 5/12/20
Cut off for questions	Fri 5/22/20
Addendum issue	Thu 5/28/20
Bids Received	Wed 6/3/20
Notice of Intent to Award issued	Tue 6/9/20
End of Protest Period	Mon 6/15/20
Notice to proceed issued by	Mon 6/22/20
Construction Begins in Field	Mon 6/29/20
Substantial Completion	<u>Wed 8/12/20</u>
Project Closeout	<u>Thu 9/3/20</u>

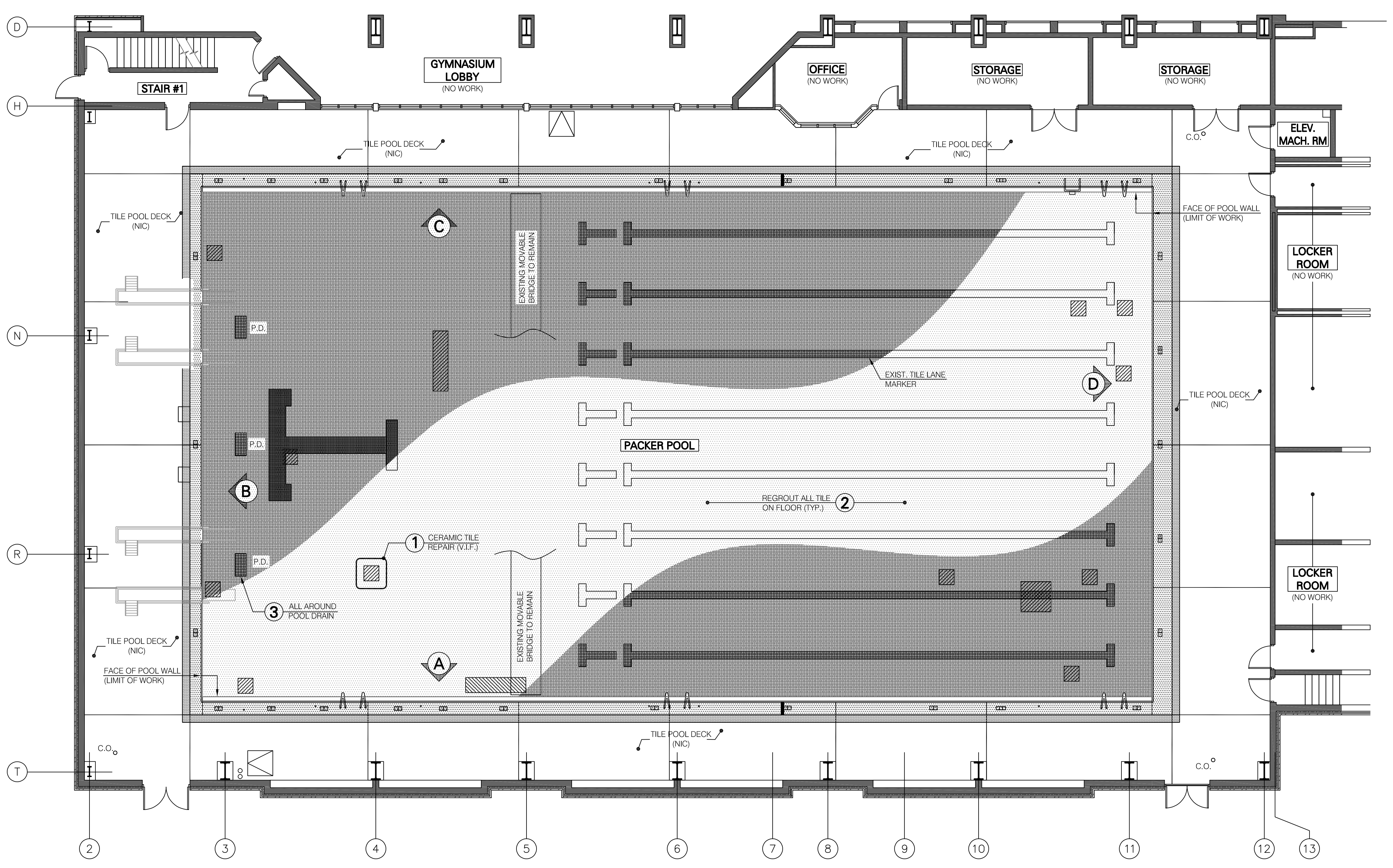

LEGEND

- EXTENT OF WORK ON POOL PLAN
- WHITE CERAMIC TILE
- BLACK CERAMIC TILE
- CONCRETE SLAB
- REPAIR TYPE

BID QUANTITY SCHEDULE

REPAIR TYPE 1 (SF)	REPAIR TYPE 2 (SF)	REPAIR TYPE 3 (LF)
850	ALL	AS NOTED

- GENERAL REPAIR PROCEDURE**
- ERECT 6 FOOT HIGH CONSTRUCTION FENCE, PROTECTION, SIGNAGE, AND ANY STAGING/STORAGE AREAS WITH FENCING. REFER TO SITE PLAN ON DRAWING PA-300
 - RELOCATE MOVEABLE BRIDGE AS REQUIRED THROUGHOUT PROJECT TO COMPLETE ALL REPAIRS IN THE POOL.
 - PERFORM TILE REPAIR AND GROUT REPLACEMENT THROUGHOUT THE ENTIRE POOL (ALL FLOOR & WALL SURFACES). REFER TO REPAIR TYPE DETAILS ON DRAWING PA-302 FOR ADDITIONAL INFORMATION.
 - TYPE 1 REPAIR - CERAMIC TILE REPAIR**
 - PERFORM SELECTIVE REMOVAL AND REPLACEMENT OF DETERIORATED AND DELAMINATED TILE AND SETTING BED MATERIALS WITHIN THE POOL.
 - PRIOR TO THE START OF WORK, THE ENGINEER WILL SOUND THE CERAMIC TILE SURFACES WITHIN THE POOL TO IDENTIFY APPROXIMATE LOCATIONS OF DELAMINATED MATERIALS. APPROXIMATE REPAIR LOCATIONS ARE SHOWN ON THE CONTRACT DRAWINGS. HOWEVER THE CONTRACTOR IS NOTIFIED SHOWN LOCATIONS ARE APPROXIMATE AND NOT ALL REPAIR LOCATIONS MAY BE SHOWN. REFER TO REPAIR SCHEDULE FOR ESTIMATED BID REPAIR QUANTITY.
 - THE CONTRACTOR SHALL INDEPENDENTLY SOUND ALL CERAMIC TILE WITHIN POOL TO IDENTIFY & CONFIRM REPAIR AREAS WITHIN THE POOL. CONTRACTOR TO CONFIRM LOCATIONS WITH THE ENGINEER AND OWNER.
 - REMOVE DELAMINATED TILE FINISHES AND SETTING BED TO EXPOSE THE CONCRETE SLAB. PREPARE & ROUGHEN CONCRETE SLAB FOR NEW WORK.
 - SOUND CONCRETE SUBSTRATE FOR ANY DETERIORATION OR DELAMINATION AND REPORT FINDINGS TO ENGINEER & OWNER.
 - INSTALL NEW SETTING BED, CERAMIC TILE AND GROUT. ALIGN TILE PATTERN AND JOINTS WITH ADJACENT EXISTING TILE. ADJUST WIDTH OF JOINTS AS NEEDED TO ALIGN TILE PATTERN.
 - TYPE 2 REPAIR - CERAMIC TILE REGROUTING**
 - PERFORM THE COMPLETE REMOVAL AND REPLACEMENT OF ALL TILE GROUT MATERIALS WITHIN THE POOL.
 - REMOVE ALL GROUT IN TILE JOINTS USING A COMBINATION OF POWER TOOL AND HAND TOOL METHODS. REMOVE ALL GROUT TO THE FULL DEPTH OF THE TILE. REMOVE ALL DIRT, DUST & DEBRIS FROM JOINTS.
 - INSTALL NEW GROUT IN ALL TILE JOINTS WITHIN THE POOL. COMPLETELY FILL ALL JOINTS WITH GROUT. INSPECT ALL JOINTS FOR VOIDS OR PIN-HOLES.
 - CLEAN ALL TILE SURFACES FOLLOWING GROUTING.
 - TYPE 3 REPAIR - SEALANT REPLACEMENT**
 - PERFORM THE COMPLETE REMOVAL AND REPLACEMENT OF ALL SEALANT MATERIALS WITHIN THE POOL.
 - REMOVE ALL EXISTING SEALANT MATERIALS BETWEEN METAL AND TILE MATERIALS (i.e. POOL GUTTER, STEPS, DRAINS, ETC.) WITHIN THE POOL. REMOVE ALL MATERIALS TO THE FULL DEPTH OF THE TILE (AT A MINIMUM).
 - INSTALL NEW SEALANT MATERIALS BETWEEN METAL AND TILE MATERIALS WITHIN THE POOL.
 - PERFORM FINAL THOROUGH WASHING AND CLEANING OF ALL SURFACES WITHIN AQUATIC CENTER THAT BECOME SOILED DURING WORK. REMOVE ALL CONSTRUCTION RELATED DIRT, DIRT AND DEBRIS FROM FINISHED POOL, POOL DECK, AND WALL SURFACES IN THE AQUATIC CENTER (AT A MINIMUM).
 - REMOVE ALL TEMPORARY FENCING, PROTECTION AND SIGNAGE FROM THE POOL AND SITE.

POOL PLAN
SCALE: 1/8"=1'-0"

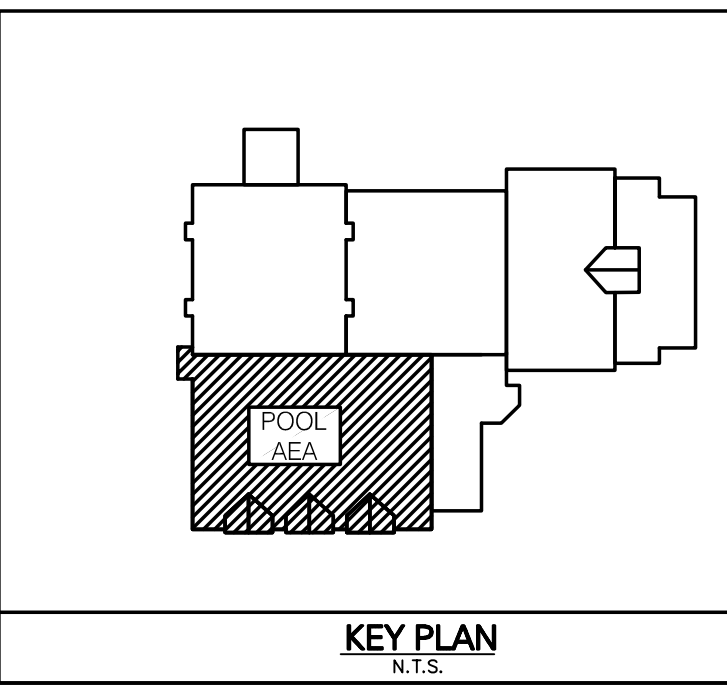
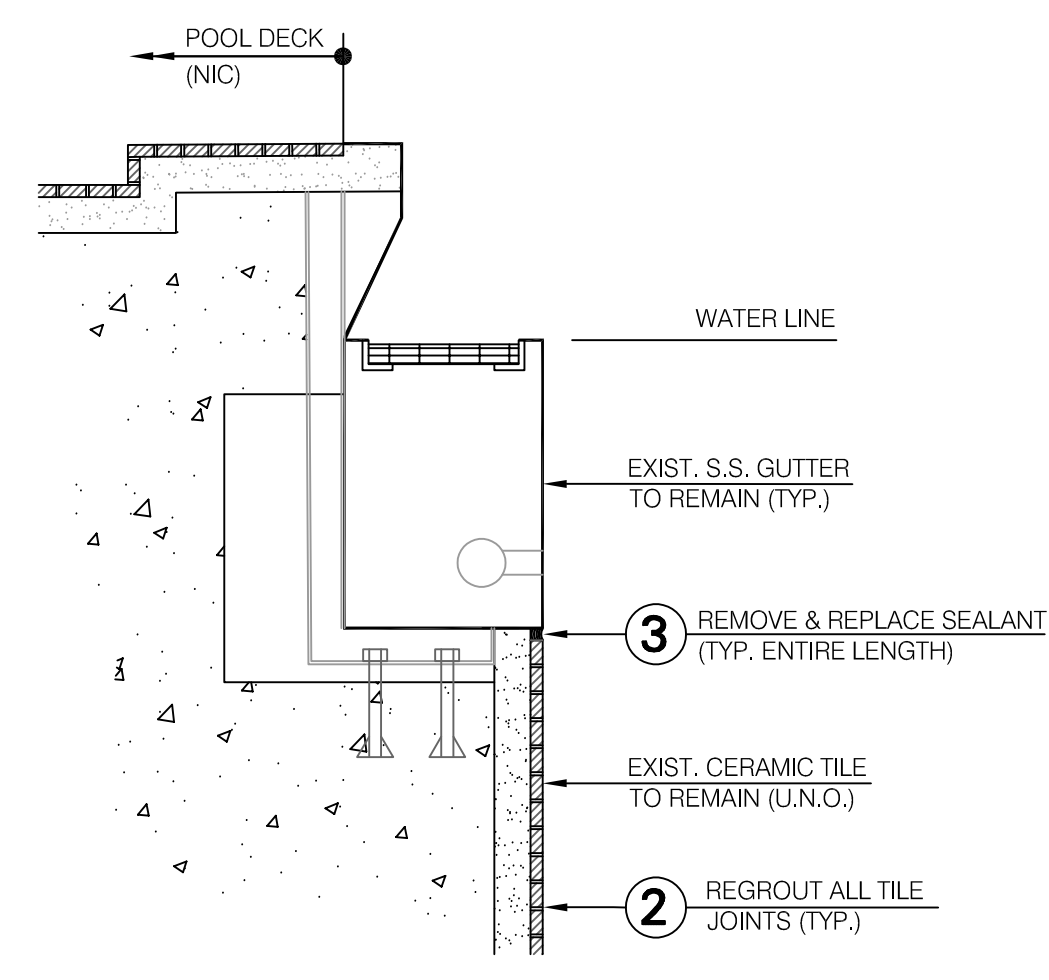
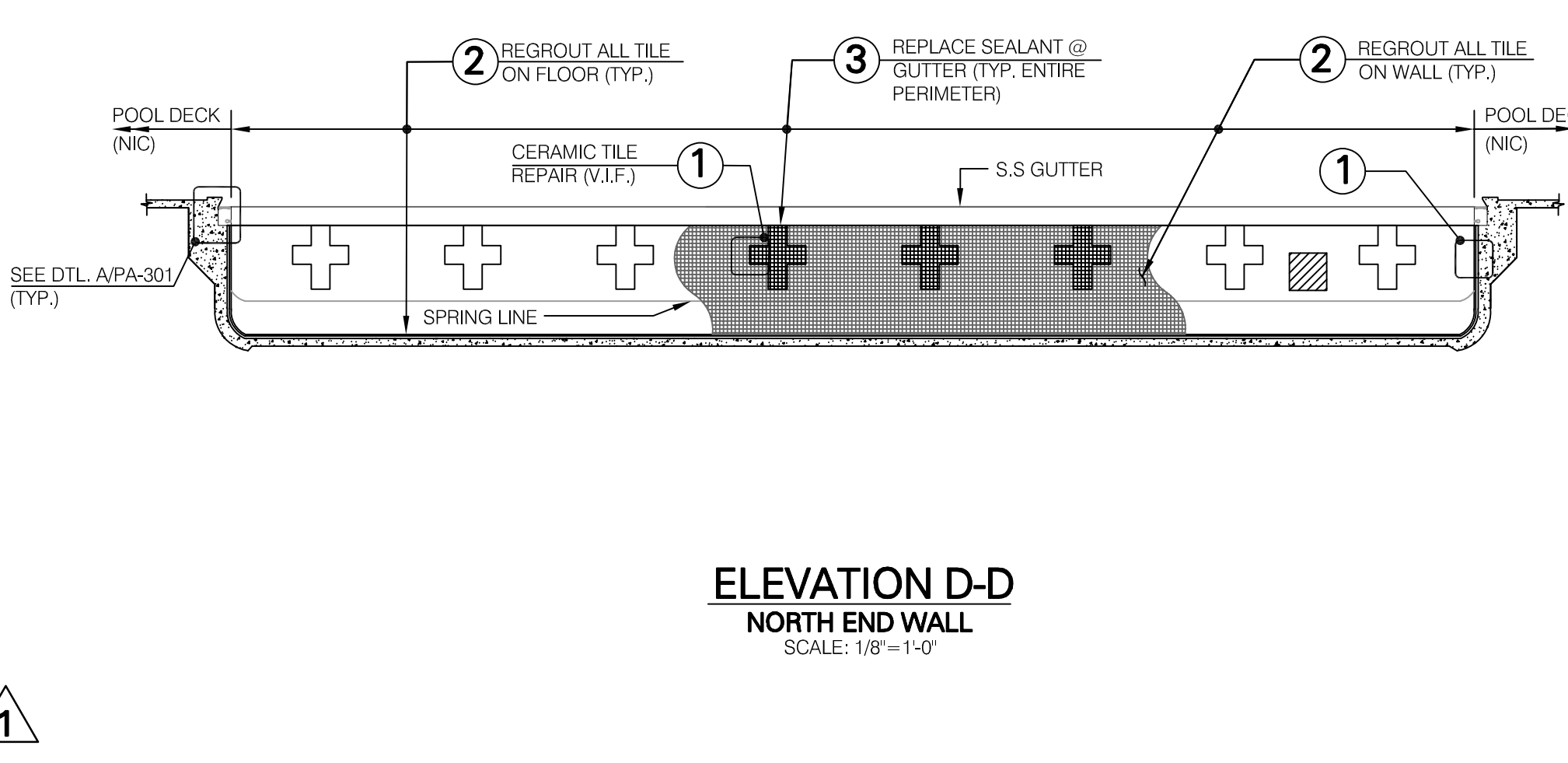
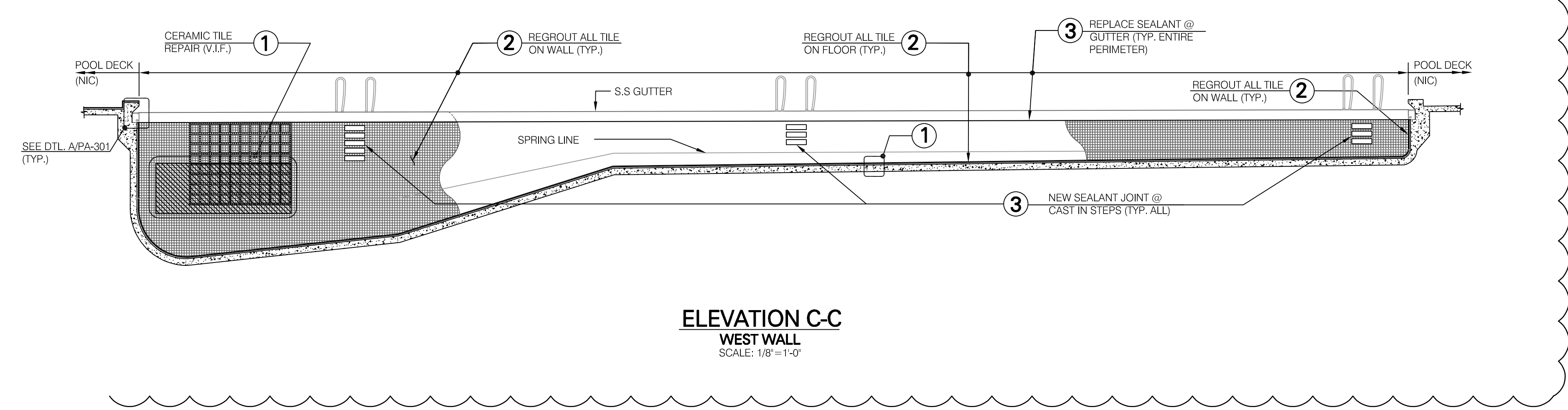
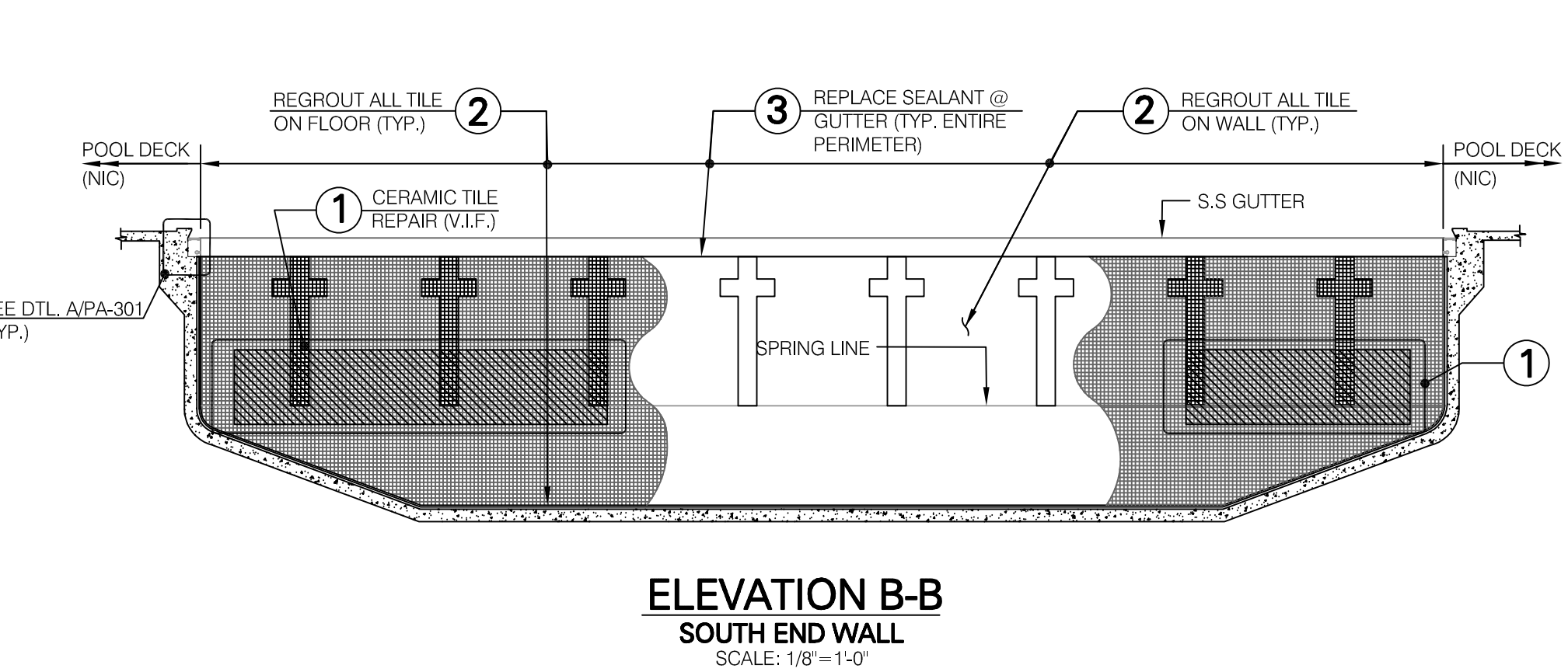
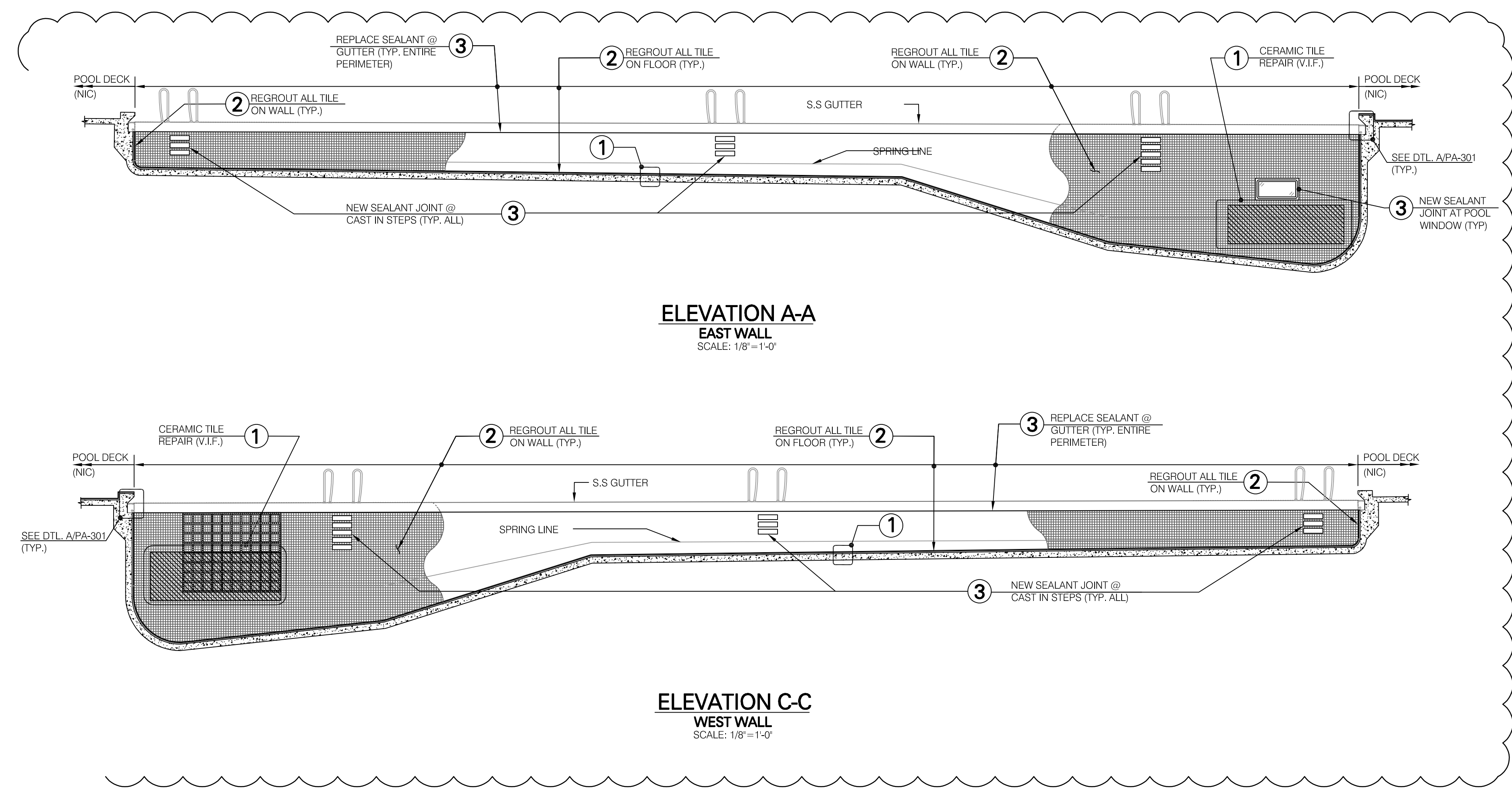

JOSEPH B. CALLAGHAN, INC.
Consulting Engineers
1617 John F. Kennedy Boulevard
P.O. Box 1000
Princeton, NJ 08540
P: (215) 665-1447
F: (215) 665-1345
www.jbcengineers.com

JBI
THE STATE OF NEW JERSEY
CERTIFICATE OF AUTHORIZATION NO. 2400202010
Joseph C. Phillips
Professional Engineer, N.J. CERT. NO. 24656792

NO.	DATE	REVISIONS	BY	TITLE
1	05/26/20	ADDENDUM NO. 1		

PACKER HALL AQUATIC CENTER
THE COLLEGE OF NEW JERSEY, EWING, NJ
TCNJ PROJECT NO. _____
POOL REPAIRS
POOL PLAN & ELEVATIONS

PROJECT NAME: _____
DRAWING SET: **ISSUE FOR BID**

DRAWN: T.J.L.	CHKD: J.P.
DATE: 04/22/20	SCALE: AS NOTED
PROJECT NO.: 20-5994	
DRAWING NO.:	

PA-301